

COMPONENT
HARDWARE®

INSTITUTIONAL CASTERS

Distributed by :
MBH International Sales, Inc.

For More Information
Email : Sales@mbhny.com



Alphabetical Index

DESCRIPTION	PAGE	DESCRIPTION	PAGE
A		S	
ACCESSORIES, CASTER	B3	SERIES C11 CASTERS	B11
ACCESSORIES, MOBILE EQUIPMENT	B18, B19	SERIES C13 CASTERS	B12
ADJUSTABLE HEIGHT CASTER	B17	SERIES C21 CASTERS	B13
B		SERIES C21-SS CASTERS	B15
BUMPERS	B18, B19	SERIES C23 CASTERS	B14
C		SERIES C23-SS CASTERS	B15
CASTER PACKS	B4, B5	SERIES 25 CASTERS	B16
CASTER SELECTION	B1	SERIES 31 CASTERS	B16
CASTER SPECIALTIES	B3	SPECIAL APPLICATION CASTERS	B2
CASTER TERMINOLOGY	B1	SPPRING RING STEM CASTERS	B10
CONTINUOUS BUMPER STRIP	B18, B19	STAINLESS STEEL CASTERS	B15
CORNER BUMPER	B18, B19	STANDARD DUTY CASTERS	
H		REGAL RIDE	B7
HEAVY DUTY CASTERS	B16	OTHERS	B11, B12
L		STRIP BUMPERS	B18, B19
LIGHT DUTY CASTERS	B11, B16	SWIVEL PLATE CASTER	B6, B7, B9, B10, B13, B14, B15, B16
M		SWIVEL STEM CASTERS	B9, B12, B14 - B15
MEDIUM DUTY CASTERS		T	
REGAL RIDE	B6, B7, B9, B10	THREADED STEM CASTERS	B10, B16
OTHERS	B8, B13 - B16	TOP LOCK BRAKE KIT	B3
MOBILE EQUIPMENT ACCESSORIES	B18, B19	3-1/2" CASTERS	B8
R		U	
RIGID CASTERS	B7, B13, B14	UTILITY CASTERS	B16
ROLLING BUMPER	B19	UNIVERSAL MOUNTING PLATE	B8
ROUND BUMPER	B19	W	
REGAL RIDE MEDIUM DUTY CASTERS		WHEELS	B2, B3
SWIVEL PLATE CASTERS	B6, B7		
THREADED STEM CASTERS	B10		
SWIVEL EXPANDING STEM CASTERS	B9		
RIGID PLATE CASTERS	B7		
REGAL RIDE STANDARD DUTY CASTERS			
SWIVEL PLATE CASTERS	B7		
THREADED STEM CASTERS	B10		

All photographs and illustrations are considered to be a representation of the actual item. In some cases there may be slight variations. This catalog, copy, part numbers and unique method of illustrating products is copyrighted by Component Hardware Group, Inc. All rights reserved. No portion of this catalog may be reproduced in any form or by any means in whole or in part, without the written consent of Component Hardware. Component Hardware reserves the right to make any and all changes and to discontinue any of its products without notice. Not responsible for typographical errors.

CASTER TERMINOLOGY

LOAD (OVERALL) HEIGHT

The vertical distance between the floor and mounting point of the equipment.

OFFSET or LEAD

The horizontal distance between vertical center lines thru the king pin and wheel center.

SWIVEL RADIUS

The horizontal distance from the vertical center line of the king pin to the outside edge of the wheel tread. This dimension specifies the minimum distance required for the caster to swivel 360 degrees when mounted.

STEM CASTER versus PLATE CASTER

Stem casters are either threaded for mounting to a tapped mounting plate or designed with a rubber expanding applicator for mounting the caster to tubing. The construction of the applicator is designed to provide maximum compression against the inside of the tubing thus ensuring a securely assembled caster.

Plate casters are provided with a plate pre-drilled with bolt mounting holes.

RIGID CASTERS

Plate models available from stock. Other styles available on application.

BRAKE and NON-BRAKE CASTERS

Standard brake is on the side of the wheel. "Top Lock" brakes are activated by a foot pedal on the top of the wheel and lock only the wheel. "Total Lock" brakes also activated by a foot pedal on the top of the wheel but lock the wheel and prevent the wheel from swiveling.

WHEEL BEARINGS

Wheel bearings may be either sintered or ball bearing types.

SINTERED

A powdered metal, oil impregnated straight bearing that is self-lubricating, long lasting and impervious to heat and cold.

BALL BEARING

A flanged, permanently lubricated bearing, pressed in on each side of the wheel hub.

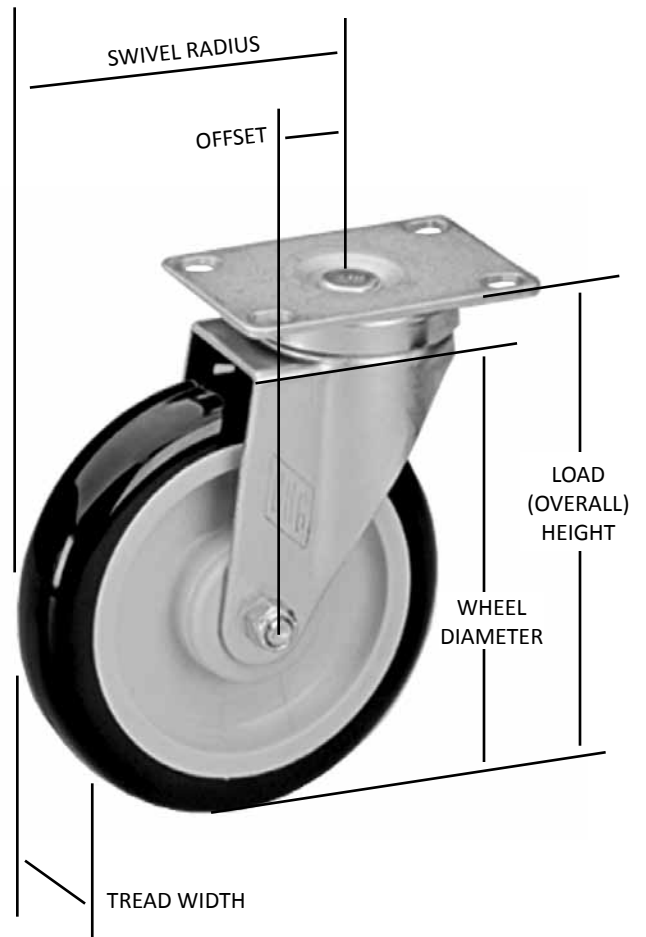

COMPONENT

NATIONAL SANITATION FOUNDATION

ALL CASTERS SHOWN IN THIS CATALOG BEARING THE NSF SEAL MEET THE REQUIRED CONSTRUCTION STANDARDS AND ARE LISTED UNDER FOOD SERVICE EQUIPMENT CRITERIA C2

CASTER SELECTION

LOAD WEIGHT

The heavier the load, the larger the wheel required for the caster. The weight of the load also influences the mobility of the wheel. Weight requirements per caster may be specified as:

Light Duty.....0-80 lbs (0-35 kg) Standard Duty.....100-200 lbs (45-90 kg)
 Medium Duty.....200-300 lbs (90-135 kg) Heavy Duty.....300-500 lbs (135-225 kg)
 Extra Heavy Duty.....500 lbs+ (225 kg+)

FLOOR CONDITIONS

The correct diameter of caster wheel is one that is large enough to pass over floor cracks and other similar obstacles. In choosing the correct caster, consideration must be given to the type of floor such as ceramic, tile, vinyl, brick or cement. Surface conditions are affected by grease, detergent, and heat. Autoclave requirements also bear on the choice of caster.

Wheels Available From Stock and On Special Application

WHEELS AVAILABLE FROM STOCK

Institutional caster wheels are offered in a large variety of types, treads, materials and sizes. The type and size of wheels chosen depends on several considerations.

1. The total overall weight of the load
2. The floor surface and conditions
3. Unusual environmental conditions such as moisture, extreme heat or cold
4. Exposure to chemicals, salt, oil, blood, fats, etc
5. Shock loading and other physical impacts
6. Noise



POLYOLEFIN WHEELS

Very economical, solid polyolefin wheels are also lightweight, hard and easy rolling. Made from durable thermoplastic, these wheels generally require no bearings and are ideal for use in corrosive conditions which can cause continual, costly, bearing replacement. Polyolefin material resists most oils, grease, solvents, acids and other chemicals. Temperature range is -20°F to 180°F (-29°C to 82°C).



POLYURETHANE WHEELS

Polyurethane wheels are manufactured with a precision molded polyurethane tire mechanically locked to a polyolefin core. They are chemical and corrosion resistant. Virtually indestructible, polyurethane wheels are at the same time economical and smart in appearance. Temperature range is -30°F to 180°F (-34°C to 82°C).



SOLID RUBBER WHEELS

All solid rubber wheels are molded of top quality rubber compounds and are non-marking. Maximum rolling efficiency and longer trouble free service are features. Temperature range is -30°F to 160°F (-34°C to 71°C).

WHEEL APPLICATION GUIDE

	CAPACITY (LBS/WHEEL)	TEMPERATURE RANGE (F)	SHORE HARDNESS
SOLID SOFT RUBBER	150-500	-30 TO + 180	95+/- 5
SOLID HARD RUBBER	150-500	-30 TO + 180	95+/- 5
POLY-LOC GRAY OR BLUE	150-500	-30 TO + 180	95+/- 5
POLYOLEFIN	100-500	-20 TO + 190	65 +/- 5
PHENOLIC	100-500	-45 TO + 250	65 +/- 5
PHENOLIC HI-TEMP	100-500	-45 TO + 450	65 +/- 5

WHEELS AVAILABLE ON SPECIAL APPLICATION



HIGH MODULUS WHEELS

HIGH MODULUS E-Z RIDER WHEELS OFFER EXTREME RESILIENCY AND MOBILITY. THESE SHOCK AND NOISE REDUCING WHEELS ARE IDEAL FOR SMOOTH, QUIET RIDE ON ROUGH OR UNEVEN FLOORS. THEY ARE ALSO NON-MARKING AND DURABLE TO WITHSTAND FREQUENT WASHING CYCLES. E-Z RIDERS ARE ESPECIALLY SUITED FOR HOSPITAL APPLICATIONS. TEMPERATURE RANGE IS -20°F TO 160°F (-29°C TO 71°C).



PHENOLIC WHEELS

PHENOLIC WHEELS ARE COMPRESSION MOLDED PHENOLIC RESIN, FILLED WITH MACERATED CANVAS. THEY ARE HARD TREAD WHEELS WITH HIGH LOAD CAPACITY AND ARE HEAT RESISTANT AND UNAFFECTED BY MOST OILS AND OTHER CHEMICALS. THEY ROLL EASILY AND MORE QUIETLY THAN STEEL OR CAST IRON, PROVIDING GREATER FLOOR PROTECTION. PHENOLIC WHEELS ARE IDEAL FOR MATERIAL HANDLING APPLICATIONS. TEMPERATURE RANGE IS -45°F TO 250°F (-43°C TO 121°C).



SOLID RUBBER WHEELS

ALL SOLID RUBBER WHEELS ARE MOLDED OF TOP QUALITY RUBBER COMPOUNDS AND ARE NON-MARKING. MAXIMUM ROLLING EFFICIENCY AND LONGER TROUBLE FREE SERVICE ARE FEATURES. TEMPERATURE RANGE IS -30°F TO 160°F (-34°C TO 71°C).



HIGH TEMPERATURE PHENOLIC WHEELS

IN ADDITION TO ALL OF THE FEATURES OF THE PHENOLIC WHEELS, HIGH TEMPERATURE PHENOLIC WHEELS OFFER A SPECIAL HIGH TEMPERATURE OPERATING RANGE OF -45°F TO 450°F (-43°C TO 230°C). THIS UNIQUE FEATURE IS ESPECIALLY IMPORTANT IN APPLICATIONS SUCH AS ROLL-IN BAKING OVENS.

CASTER SPECIALTIES AND ACCESSORIES

THE FOLLOWING CASTER SPECIALTIES AND ACCESSORIES ILLUSTRATED ARE REPRESENTATIVE OF THE RANGE OF SPECIALTY CASTER DESIGNS AVAILABLE. TECHNICAL ASSISTANCE IS AVAILABLE FOR SPECIAL REQUIREMENTS.



THREADED STEM CASTERS

COMPLEMENTING THE STOCK CASTERS FEATURED IN THIS CATALOG IS A WIDE RANGE OF THREADED STEM CASTERS AVAILABLE TO ACCOMMODATE SPECIAL REQUIREMENTS. AMONG THE THREADED STEMS MOST COMMONLY USED AND AVAILABLE ARE:

1/2-13 x 3/4" (19 mm) 1/2-13 x 1" (25 mm) 5/8-11 x 1-3/4" (44 mm)
5/8-18 x 1-3/4" (44 mm) 3/4-10 x 1-3/4" (44 mm)



STEMS FOR SPECIAL APPLICATIONS

COMPONENT HARDWARE GROUP ALSO OFFERS A VARIETY OF SPECIALTY STEM CASTERS INCLUDING THOSE WITH STEMS DESIGNED WITH DRILLED HOLES AND SPRING RINGS. ALSO OFFERED ARE SQUARE, HEXAGONAL OR OCTAGONAL SHAPED STEMS.



ZERK GREASE FITTINGS AND SEALS

ZERK GREASE FITTINGS AND SEALS ARE RECOMMENDED WHEN IT IS IMPORTANT TO MAINTAIN GOOD CASTER LUBRICATION FOR EASIER CASTER SWIVELING AND LONGER BEARING LIFE. ZERK GREASE FITTINGS PROVIDE A CONVENIENT METHOD OF LUBRICATION. THE SEALS EFFECTIVELY RETAIN THE LUBRICANT WHILE PREVENTING DIRT OR MOISTURE FROM ENTERING THE LUBRICATED AREAS. SEALS ARE EFFECTIVE TOO, WHERE EQUIPMENT IS EXPOSED TO FREQUENT WASHINGS OR STERILIZATION CYCLES. SEALS USED AT THE SWIVEL OR AXLE BEARING, OFFER HIGH RESISTANCE TO GREASE, OILS, CHEMICALS AND DETERGENTS.



MOUNTING PLATES

IN ADDITION TO THE STOCK MOUNTING PLATES SHOWN IN THIS CATALOG, ADDITIONAL SIZES ARE OFFERED TO MATCH A WIDE VARIETY OF BOLT HOLE PATTERNS CURRENTLY USED BY MOST CASTER MANUFACTURERS.



TOP LOCK CASTER

- SOLD SEPARATELY OR AS PART OF OUR FINISHED CASTER
 - STAINLESS STEEL CONSTRUCTION
 - LARGE ON/OFF PEDAL FOR EASY OPERATION
- FORM-FITTING TEETH LOCK THE LOWER RACE FOR FULL STRENGTH ENGAGEMENT.
- SIMPLE AND EFFECTIVE WITH QUICK ENGAGEMENT AND RELEASE

TOP LOCK CAN BE RETROFITTED TO MOST POPULAR CASTERS USING KITS.

TOP LOCK BRAKE KIT - MODEL NO. CTB-1500

AVAILABLE FOR ALL TYPES OF REGAL RIDE™ 5" CASTERS

BRAKE MECHANISM:

"TOP LOCK" BRAKE -
PRESS THE BRAKE PEDAL AND LOCK THE WHEEL.

Regal Ride Caster Packs



MODEL NO.	DUTY	MOUNTING STYLE	CASTERS	WHEEL DIA.	WHEEL TYPE	PACK
CSTPK-1PUP-4B	Medium	3-1/2" X 3-1/2" Plate, Low Profile	N/A	1"	Black Polyolefin	With Brake, 4 Pack
CSTPK-2PUP-4B	Medium	3-1/2" X 3-1/2" Plate, Low Profile	N/A	2"	Black Polyolefin	With Brake, 4 Pack
CSTPK-2PUTS-B	Medium	1/2"-13 x 1 Threaded Stem	N/A	2"	Blue Polyolefin	With Brake, 4 Pack
CSTPK-3BTS	Medium	1/2" - 13 x 1-1/2" Threaded Stem	(2) CMT1-3BBN (2) CMT1-3BPN	3"	Black Polyolefin	2 Brake/2 Non Brake
CSTPK-3BTS-7B	Medium	1/2" - 13 x 3/4" Threaded Stem	(4) CMT4-3BBN	3"	Black Polyolefin	With Brake, 4 Pack
CSTPK-3BTS-B	Medium	1/2" - 13 x 1-1/2" Threaded Stem	(2) CMT1-3BBN (2) CMT1-3BPN	3"	Black Polyolefin	With Brake, 4 Pack
CSTPK-3PAL	Medium	3-1/2" x 3-1/2" Square Plate With Adjustable Stem	(4) C48-03185-C	3"	Black Polyolefin	2 Brake/2 Non Brake
CSTPK-3PAL-1	Medium	3-1/2" x 3-1/2" Square Plate With Adjustable Stem	(2) C47-0306-C (2) C47-0316-C	3"	Black Polyolefin	2 Brake/2 Non Brake
CSTPK-3PES	Medium	1-5/8" Expanding Stem	(2) CMS4-3BBN (2) CMS4-3BPN	3"	Black Polyolefin	2 Brake/2 Non Brake
CSTPK-3PRS	Medium	Spring Ring Stem For Shelving Posts	(2) C99-1030 (2) C99-1031	3"	Black Polyolefin	2 Brake/2 Non Brake
CSTPK-3PSP	Medium	2-3/8" x 3-5/8" Swivel Plate	(2) CMP1-3BBN (2) CMP1-3BPN	3"	Black Polyolefin	2 Brake/2 Non Brake
CSTPK-3PUES-3	Medium	1-1/2" Expanding Stem	(2) CMS3-3PBB (2) CMS3-3PPB	3"	Blue Polyurethane	2 Brake/2 Non Brake
CSTPK-3PUES-3B	Medium	1-1/2" Expanding Stem	(4) CMS3-3PBB	3"	Blue Polyurethane	With Brake, 4 Pack
CSTPK-3PUES-4	Medium	1-5/8" Expanding Stem	(2) CMS4-3PPB (2) CMS4-3PBB	3"	Blue Polyurethane	2 Brake/2 Non Brake
CSTPK-3PUES-4B	Medium	1-5/8" Expanding Stem	(4) CMS4-3PBB	3"	Blue Polyurethane	With Brake, 4 Pack
CSTPK-3PUUP-B	Medium	4" X 4" Universal Plate	N/A	3"	Blue Polyurethane	With Brake, 4 Pack
CSTPK-3PUUP-4B	Medium	3-1/2" X 3-1/2" Universal Plate	N/A	3"	Blue Polyurethane	With Brake, 4 Pack
CSTPK-4PBB	Medium	4" x 4-1/2" Swivel Plate	(2) CMP6-35PPB (2) CMP6-35PBB	4"	Blue Polyurethane	2 Brake/2 Non Brake
CSTPK-4PSP	Medium	2-3/8" X 3-5/8" Swivel Plate	(2) CMP1-4BPN (2) CMP1-4BBN	4"	Black Polyolefin	2 Brake/2 Non Brake
CSTPK-4PUTS-1B	Medium	1/2"- 13 X 1" Threaded Stem	(4) CMT4-4PBB	4"	Blue Polyurethane	With Brake, 4 Pack
CSTPK-4RES	Medium	1-5/8" Expanding Stem	(2) CMS4-4RPB (2) CMS4-4RBB	4"	Grey Polyurethane	2 Brake/2 Non Brake
CSTPK-5BTS	Medium	1/2" - 13 1-1/2" Threaded Stem	(2) CMT1-5BBN (2) CMT1-5BPN	5"	Black Polyolefin	2 Brake/2 Non Brake
CSTPK-5BUP	Medium	4" x 4" Universal Plate	(2) CMPU-5PBB (2) CMPU-5PPB	5"	Blue Polyurethane	2 Brake/2 Non Brake
CSTPK-5HPUSP-5	Heavy	Triangular Plate	(2) CHP5-5PBB (2) CHP5-5PPB	5"	Blue Polyurethane	2 Brake/2 Non Brake
CSTPK-5PES	Medium	1-5/8" Expanding Stem	(2) CMS4-5BBN (2) CMS4-5BPN	5"	Black Polyolefin	2 Brake/2 Non Brake
CSTPK-5PES-1	Medium	1" Expanding Stem	(2) CMS1-5BBN (2) CMS1-5BPN	5"	Black Polyolefin	2 Brake/2 Non Brake
CSTPK-5PES-2	Medium	1-1/4" Expanding Stem	(2) CMS2-5BBN (2) CMS2-5BPN	5"	Black Polyolefin	2 Brake/2 Non Brake
CSTPK-5PES-3	Medium	1-1/2" Expanding Stem	(2) CMS3-5BBN (2) CMS3-5BPN	5"	Black Polyolefin	2 Brake/2 Non Brake
CSTPK-5PES-4B-6	Medium	1-5/8" Expanding Stem	(6) CMS4-5PBB	5"	Black Polyolefin	With Brake, 6 Pack

Regal Ride Caster Packs



MODEL NO.	DUTY	MOUNTING STYLE	CASTERS	WHEEL DIA.	WHEEL TYPE	PACK
CSTPK-5PFC-B	Medium	Female Collar	N/A	5"	Blue Polyurethane	With Brake, 4 Pack
CSTPK-5PRS	Medium	Spring Ring Stem For Shelving Posts	(2) C99-1050 (2) C99-1051	5"	Black Polyolefin	2 Brake/2 Non Brake
CSTPK-5PRS-B	Medium	Spring Ring Stem For Shelving Posts	(4) C99-1051	5"	Black Polyolefin	With Brake, 4 Pack
CSTPK-5PRS-SP1	Medium	Spring Ring Stem For Shelving Posts with bumpers	(2) C99-1050 (2) C99-1051	5"	Black Polyolefin	2 Brake/2 Non Brake
CSTPK-5PSP	Medium	2-3/8" x 3-5/8" Swivel Plate	(2) CMP1-5BBN (2) CMP1-5BPN	5"	Black Polyolefin	2 Brake/2 Non Brake
CSTPK-5PTS	Medium	Threaded Stem	(2) CMT3-5BPN (2) CMT3-5BBN	5"	Black Polyolefin	2 Brake/2 Non Brake
CSTPK-5PUES-3B	Medium	1-1/2" Expanding Stem	(4) CMS3-5PBB	5"	Grey Polyurethane	With Brake, 4 Pack
CSTPK-5PUES-4B	Medium	1-5/8" Expanding Stem	(4) CMS4-5PBB	5"	Grey Polyurethane	With Brake, 4 Pack
CSTPK-5PUES-4B-6	Medium	1-5/8" Expanding Stem	(6) CMS4-5PBB	5"	Grey Polyurethane	With Brake, 6 Pack
CSTPK-5PUP	Medium	4" x 4" Universal Plate	(2) CMPU-5BPN (2) CMPU-5BBN	5"	Black Polyolefin	2 Brake/2 Non Brake
CSTPK-5PUP-4	Medium	4" x 4" Universal Plate	N/A	5"	Black Polyolefin	2 Brake/2 Non Brake
CSTPK-5PURS	Medium	1" Spring Ring Stem	(2) C99-3050 (2) C99-3051	5"	Grey Polyurethane	2 Brake/2 Non Brake
CSTPK-5PURS-B	Medium	1" Spring Ring Stem	(4) C99-3051	5"	Grey Polyurethane	With Brake, 4 Pack
CSTPK-5PUSP	Medium	2-3/8" x 3-5/8" Swivel Plate	(2) CMP1-5RPB (2) CMP1-5RBB	5"	Grey Polyurethane	2 Brake/2 Non Brake
CSTPK-5PUSP-B	Medium	2-3/8" x 3-5/8" Swivel Plate	(4) CMP1-5PBB	5"	Grey Polyurethane	With Brake, 4 Pack
CSTPK-5PUTS-1B	Medium	1/2" - 13 x 1-1/2" Threaded Stem	(4) CMT1-5PBB	5"	Blue Polyurethane	With Brake, 4 Pack
CSTPK-5PUTS-2B	Medium	5/8" - 11 x 1" Threaded Stem	(4) CMT5-5PBB	5"	Blue Polyurethane	With Brake, 4 Pack
CSTPK-5PUTS-3B	Medium	3/4" - 10 x 1" Threaded Stem	N/A	5"	Blue Polyurethane	With Brake, 4 Pack
CSTPK-5PUTS-4	Medium	1/2" - 13 x 1" Threaded Stem	(2) CMT4-5PPB (2) CMT4-5PBB	5"	Blue Polyurethane	2 Brake/2 Non Brake
CSTPK-5PUUP	Medium	3-1/2" x 3-1/2" Universal Plate	(2) CMP4U-5PPB (2) CMP4U-5PBB	5"	Blue Polyurethane	2 Brake/2 Non Brake
CSTPK-5PUUP-4B	Medium	3-1/2" x 3-1/2" Universal Plate	(4) CMP4-5PBB	5"	Blue Polyurethane	With Brake, 4 Pack
CSTPK-5PUUP-B	Medium	4" x 4" Universal Plate	(4) CMPU-5PBB	5"	Blue Polyurethane	With Brake, 4 Pack
CSTPK-5RES	Medium	1-5/8" Expanding Stem	(2) CMS4-5RBB (2) CMS4-5RPB	5"	Grey Polyurethane	2 Brake/2 Non Brake
CSTPK-5RES-3	Medium	1-1/2" Expanding Stem	(2) CMS3-5RBB (2) CMS3-5RPB	5"	Grey Polyurethane	2 Brake/2 Non Brake
CSTPK-5RSP	Medium	2-3/8" X 3-5/8" Swivel Plate	(2) CMP1-5RPB (2) CMP1-5RBB	5"	Grey Polyurethane	2 Brake/2 Non Brake
CSTPK-5RSP-T1	Medium	2-3/8" X 3-5/8" Swivel Plate	(2) CMP1-5RPB-B (2) CMP1-5RTB-B	5"	Grey Polyurethane	2 TopLock/2 Non
CSTPK-5RTS-1	Medium	1/2" - 13 1-1/2" Threaded Stem	(2) CMT1-5RBB (2) CMT1-5RPB	5"	Grey Polyurethane	2 Brake/2 Non Brake
CSTPK-5RUP	Medium	4" x 4" Universal Plate	(2) CMPU-5RBB (2) CMPU-5RPB	5"	Grey Polyurethane	2 Brake/2 Non Brake
CSTPK-6PBB	Medium	4" x 4-1/2" Swivel Plate	(2) CMP6-5PPB (2) CMP6-5PBB	6"	Blue Polyurethane	2 Brake/2 Non Brake

Regal Ride™ Medium Duty Swivel Plate Casters

REGAL RIDE
CASTER



MEDIUM DUTY SWIVEL PLATE CASTERS

- FULL 1-1/4" (32mm) TREAD WIDTH
- LOAD CAPACITY 250 lbs (110 kg) PER WHEEL
- CHOICE OF POLYOLEFIN OR POLYURETHANE WHEELS
- BRAKE AND NON-BRAKE MODELS
- PROVIDED WITH HEAVY 9 GAUGE (4mm) MOUNTING PLATE



MOUNTING PLATE SIZE:
 2-3/8" x 3-5/8" (60mm x 92mm) WITH HOLE OPENINGS SPACED ON
 1-3/4" x 3" (44mm x 76mm) CENTERS TO ACCEPT 1/4" OR 5/16" (6mm or 8mm) DIA. BOLTS
 FOR PLATE HOLE PATTERN CONFIGURATION, REFER TO PG. B20-21.

MEDIUM DUTY SWIVEL PLATE CASTERS

CASTER CONFIGURATION DATA			BLACK POLYOLEFIN WHEELS LOAD CAPACITY: 250 lbs (110 kg)		BLACK RUBBER WHEELS LOAD CAPACITY: 200 lbs (90 kg) *250 lbs (110 kg)		GRAY POLYURETHANE WHEELS FURNISHED WITH BALL BEARINGS LOAD CAPACITY: 250 lbs (110 kg)		DARK BLUE POLYURETHANE WHEELS FURNISHED WITH BALL BEARINGS LOAD CAPACITY: 250 lbs (110 kg)	
WHEEL DIA.	LOAD HEIGHT	SWIVEL RADIUS	NON-BRAKE MODEL NO.	BRAKE MODEL NO.	NON-BRAKE MODEL NO.	BRAKE MODEL NO.	NON-BRAKE MODEL NO.	BRAKE MODEL NO.	NON-BRAKE MODEL NO.	BRAKE MODEL NO.
3" (76mm)	4" (102mm)	2-7/8" (73mm)	CMP1-3BPN	CMP1-3BBN	CMP1-3KPN	CMP1-3KBN	-	-	CMP1-3PPB	CMP1-3PBB
4" (102mm)	5" (127mm)	3-3/8" (86mm)	CMP1-4BPN	CMP1-4BBN	CMP1-4KPN	CMP1-4KBN	CMP1-4RPB	CMP1-4RBB	CMP1-4PPB	CMP1-4PBB
5" (127mm)	6" (152mm)	4" (102mm)	CMP1-5BPN	CMP1-5BBN	CMP1-5KPN*	CMP1-5KBN*	CMP1-5RPB	CMP1-5RBB	CMP1-5PPB	CMP1-5PBB
			-	-	-	-	CMP1-5RPB-B	-	-	-
			-	-	-	-	-	CMP1-5RBB-TB**	-	-

**Top Brake

Regal Ride™ Rigid, Swivel Plated, & Threaded Casters



MEDIUM DUTY RIGID PLATE CASTERS

- LOAD CAPACITY OF 250 lbs PER WHEEL
- FULL 1-1/4" (32mm) TREAD WIDTH • NON-BRAKE MODELS ONLY
- CHOICE OF POLYOLEFIN, POLYURETHANE OR RUBBER WHEELS



MOUNTING PLATE SIZE:*
 2-3/8" x 3-5/8" (60mm x 92mm) WITH HOLE OPENINGS SPACED ON
 1-3/4" x 3" (44mm x 76mm) CENTERS TO ACCEPT 1/4" OR 5/16" (6mm or 8mm) DIA. BOLTS

MEDIUM DUTY RIGID PLATE CASTERS						
CASTER CONFIGURATION DATA			BLACK POLYOLEFIN WHEELS LOAD CAPACITY: 250 lbs (110 kg)	BLACK RUBBER WHEELS LOAD CAPACITY: 200 lbs (90 kg) 250 lbs (110 kg)	GRAY POLYURETHANE WHEELS FURNISHED WITH BALL BEARINGS LOAD CAPACITY: 250 lbs (110 kg)	DARK BLUE POLYURETHANE WHEELS FURNISHED WITH BALL BEARINGS LOAD CAPACITY: 250 lbs (110 kg)
WHEEL DIA.	LOAD HEIGHT	SWIVEL RADIUS	MODEL NO.	MODEL NO.	MODEL NO.	MODEL NO.
3" (76mm)	4" (102mm)	-	CMR1-3BPN	CMR1-3KPN	-	CMR1-3PPB
4" (102mm)	5" (127mm)	-	CMR1-4BPN	CMR1-4KPN	CMR1-4RPB	CMR1-4PPB
5" (127mm)	6" (152mm)	-	CMR1-5BPN	CMR1-5KPN	CMR1-5RPB	CMR1-5PPB



STANDARD DUTY SWIVEL PLATE CASTERS*

- 3" x 1-3/8" WIDE (76mm x 35mm) BLACK POLYOLEFIN WHEELS
- BRAKE AND NON-BRAKE MODELS
- LOAD CAPACITY OF 100 lbs (45 kg) PER WHEEL SELECTED

CASTER CONFIGURATION DATA			SWIVEL PLATE 2-3/4" X 3-3/4" (70mm x 95mm) HOLE OPENINGS SPACED ON 1-3/4" X 3" (44mm X 76mm) CENTERS TO ACCEPT 1/4" (6mm) DIA. BOLTS	
WHEEL DIA.	LOAD HEIGHT	SWIVEL RADIUS	NON-BRAKE MODEL NO.	BRAKE MODEL NO.
3" (76mm)	3-3/4" (95mm)	2-3/4" (70mm)	CLP2-3BPN	CLP2-3BBN



*FOR PLATE HOLE PATTERN CONFIGURATION, REFER TO PG. B20-21.

Universal Mounting Plate and 3-1/2" Casters

UNIVERSAL MOUNTING PLATE CASTERS

- REDUCES REQUIRED CASTER INVENTORY WHILE PROVIDING MOUNTING FLEXIBILITY
- BOLT HOLE PATTERNS ACCOMMODATE EASY INTERCHANGEABILITY BETWEEN EQUIPMENT LEGS AND CASTERS
- 9-GAUGE ZINC PLATED STEEL MOUNTING PLATE
- 5/16" DIAMETER SLOTTED MOUNTING HOLES FOR EASY ADJUSTABILITY
 - LOCKING AND NON-LOCKING MODELS
 - LOAD CAPACITY 250 lbs.(110 kg) PER WHEEL
 - FULL 1-1/4" TREAD WIDTH



COMPONENT

4" x 4" UNIVERSAL MOUNTING PLATE*										
CASTER CONFIGURATION DATA			BLACK POLYOLEFIN WHEELS LOAD CAPACITY: 250 lbs (110 kg)		BLACK RUBBER WHEELS LOAD CAPACITY: 250 lbs (110 kg)		GRAY POLYURETHANE WHEELS FURNISHED WITH BALL BEARINGS LOAD CAPACITY: 250 lbs (110 kg)		DARK BLUE POLYURETHANE WHEELS FURNISHED WITH BALL BEARINGS LOAD CAPACITY: 250 lbs (110 kg)	
WHEEL DIA.	LOAD HEIGHT	SWIVEL RADIUS	NON-BRAKE MODEL NO.	BRAKE MODEL NO.	NON-BRAKE MODEL NO.	BRAKE MODEL NO.	NON-BRAKE MODEL NO.	BRAKE MODEL NO.	NON-BRAKE MODEL NO.	BRAKE MODEL NO.
5" (127mm)	6" (152mm)	4" (101mm)	CMPU-5BPN	CMPU-5BBN	CMPU-5KPN	CMPU-5KBN	CMPU-5RPB	CMPU-5RBB	CMPU-5PPB	CMPU-5PBB
3-1/2" x 3-1/2" UNIVERSAL MOUNTING PLATE*										
5" (127mm)	6" (152mm)	4" (101mm)	CMP4-5BPB	CMP4-5BBB	-	-	-	-	CMP4U-5PPB	CMP4U-5PBB

MEDIUM DUTY 3-1/2" PLATE & EXPANDING STEM CASTERS

- AVAILABLE FOR MOUNTING PLATE AND EXPANDING FASTENER APPLICATIONS
- LOCKING AND NON-LOCKING MODELS • LOAD CAPACITY 200 lbs (90 kg) PER WHEEL
- FULL 1-1/4" TREAD WIDTH



COMPONENT

MEDIUM DUTY 3-1/2" PLATE & EXPANDING STEM CASTERS						
CASTER CONFIGURATION DATA				BLACK RUBBER WHEELS LOAD CAPACITY: 200 lbs (90 kg)		
APPLICATION	WHEEL DIA.	LOAD HEIGHT	SWIVEL RADIUS	NON-BRAKE MODEL NO.	BRAKE MODEL NO.	
PLATE CASTER*	3-1/2" (89mm)	4-7/16" (113mm)	3-1/4" (83mm)	CMP1-35KPN	CMP1-35KBN	
1" (25mm) STEM CASTER	3-1/2" (89mm)	4-7/16" (113mm)	3-1/4" (83mm)	CMS1-35KPN	CMS1-35KBN	
1-1/4" (31mm) STEM CASTER	3-1/2" (89mm)	4-7/16" (113mm)	3-1/4" (83mm)	CMS2-35KPN	CMS2-35KBN	
1-1/2" (38mm) STEM CASTER	3-1/2" (89mm)	4-7/16" (113mm)	3-1/4" (83mm)	CMS3-35KPN	CMS3-35KBN	
1-5/8" (40mm) STEM CASTER	3-1/2" (89mm)	4-7/16" (113mm)	3-1/4" (83mm)	CMS4-35KPN	CMS4-35KBN	
2" (51mm) STEM CASTER	3-1/2" (89mm)	4-7/16" (113mm)	3-1/4" (83mm)	CMS5-35KPN	CMS5-35KBN	



*FOR PLATE HOLE PATTERN CONFIGURATION, REFER TO PG. B20-21.

Regal Ride™ Medium Duty Swivel Expanding Stem Casters

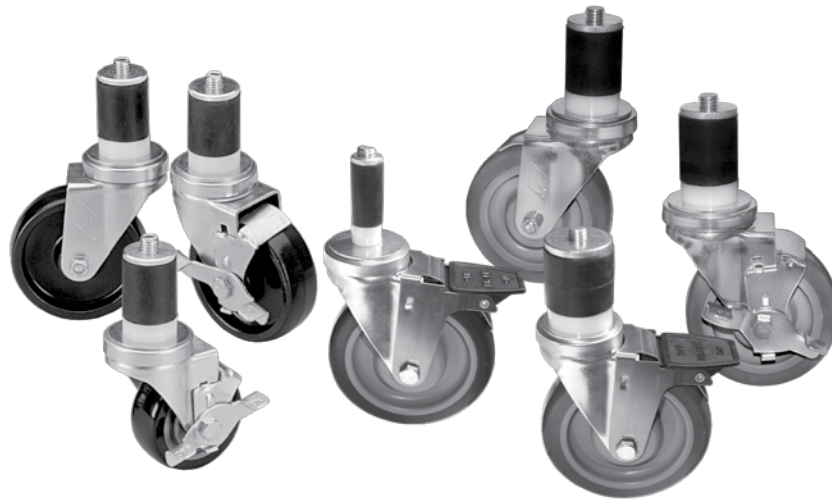

MEDIUM DUTY SWIVEL EXPANDING STEM CASTERS

- FULL 1-1/4" (32mm) TREAD WIDTH • LOAD CAPACITY 250 lbs (110 kg) PER WHEEL
- CHOICE OF POLYOLEFIN, POLYURETHANE OR RUBBER WHEELS • BRAKE AND NON-BRAKE MODELS
- ADAPTS TO EITHER ROUND OR SQUARE TUBING



APPLICATION IS BASED ON O.D. OF EITHER ROUND OR SQUARE COMMERCIAL TUBING.
CASTERS EXPAND TO FIT 16, 18 OR 20 GAUGE (1.5mm, 1.2mm or 1mm) WALL THICKNESS.

MEDIUM DUTY EXPANDING STEM CASTERS

CASTER CONFIGURATION DATA				BLACK POLYOLEFIN WHEELS LOAD CAPACITY: 250 lbs. (110 kg.)		BLACK RUBBER WHEELS LOAD CAPACITY: 200 lbs. (90 kg.) **250 lbs. (110 kg.)		GRAY POLYURETHANE WHEELS FURNISHED WITH BALL BEARINGS LOAD CAPACITY: 250 lbs. (110 kg.)		DARK BLUE POLYURETHANE WHEELS FURNISHED WITH BALL BEARINGS LOAD CAPACITY: 250 lbs. (110 kg.)	
APPLI- CATION	WHEEL DIA.	LOAD HEIGHT	SWIVEL RADIUS	NON-BRAKE MODEL NO.	BRAKE MODEL NO.	NON-BRAKE MODEL NO.	BRAKE MODEL NO.	NON-BRAKE MODEL NO.	BRAKE MODEL NO.	NON-BRAKE MODEL NO.	BRAKE MODEL NO.
1" (25mm) DIA. TUBING ROUND or SQUARE	3" (76mm)	4" (102mm)	2-7/8" (73mm)	CMS1-3BPN	CMS1-3BBN	-	-	-	-	CMS1-3PPB	CMS1-3PBB
	4" (102mm)	5" (127mm)	3-3/8" (86mm)	CMS1-4BPN	CMS1-4BBN	-	CMS1-4KBN	CMS1-4RPB	CMS1-4RBB	CMS1-4PPB	CMS1-4PBB
	5" (127mm)	6" (152mm)	4" (102mm)	CMS1-5BPN	CMS1-5BBN	CMS1-5KPN**	CMS1-5KBN**	CMS1-5RPB	CMS1-5RBB	CMS1-5PPB	CMS1-5PBB CMS1-5PPB-TB***
1-1/4" (32mm) DIA. TUBING ROUND or SQUARE	3" (76mm)	4" (102mm)	2-7/8" (73mm)	CMS2-3BPN	CMS2-3BBN	-	-	-	-	CMS2-3PPB	CMS2-3PBB
	4" (102mm)	5" (127mm)	3-3/8" (86mm)	CMS2-4BPN	CMS2-4BBN	CMS2-4KPN	CMS2-4KBN	CMS2-4RPB	CMS2-4RBB	CMS2-4PPB	CMS2-4PBB
	5" (127mm)	6" (152mm)	4" (102mm)	CMS2-5BPN	CMS2-5BBN	CMS2-5KPN**	CMS2-5KBN**	CMS2-5RPB	CMS2-5RBB CMS2-5RBB-TB***	CMS2-5PPB	CMS2-5PBB
1-1/2" (38mm) DIA. TUBING ROUND or SQUARE or 1-1/4" PIPE	3" (76mm)	4" (102mm)	2-7/8" (73mm)	CMS3-3BPN	CMS3-3BBN	-	-	-	-	CMS3-3PPB	CMS3-3PBB
	4" (101mm)	5" (127mm)	3-3/8" (86mm)	CMS3-4BPN	CMS3-4BBN	CMS3-4KPN	CMS3-4KBN	CMS3-4RPB	CMS3-4RBB	CMS3-4PPB	CMS3-4PBB
	5" (127mm)	6" (152mm)	4" (102mm)	CMS3-5BPN	CMS3-5BBN	-	-	CMS3-5RPB	CMS3-5RBB CMS3-5RBB-TB***	CMS3-5PPB	CMS3-5PBB
1-5/8" (40mm) DIA. TUBING ROUND or SQUARE	3" (76mm)	4" (102mm)	2-7/8" (73mm)	CMS4-3BPN	CMS4-3BBN	CMS4-3KPN	CMS4-3KBN	-	-	CMS4-3PPB	CMS4-3PBB
	4" (102mm)	5" (127mm)	3-3/8" (86mm)	CMS4-4BPN CMS4-4BPNS*	CMS4-4BBN CMS4-4BBNS*	CMS4-4KPN	CMS4-4KBN	CMS4-4RPB	CMS4-4RBB	CMS4-4PPB	CMS4-4PBB
	5" (127mm)	6" (152mm)	4" (102mm)	CMS4-5BPN	CMS4-5BBN CMS4-5BBN-TB***	CMS4-5KPN**	CMS4-5KBN**	CMS4-5RPB	CMS4-5RBB CMS4-5RBB-TB***	CMS4-5PPB CMS4-5PPB-SS*	CMS4-5PBB CMS4-5PBB-SS* CMS4-5PBB-TB***
2" (51mm) DIA. TUBING ROUND or SQUARE	3" (76mm)	4" (102mm)	2-7/8" (73mm)	CMS5-3BPN	CMS5-3BBN	-	-	-	-	CMS5-3PPB	CMS5-3PBB
	4" (102mm)	5" (127mm)	3-3/8" (86mm)	CMS5-4BPN	CMS5-4BBN	-	-	CMS5-4RPB	CMS5-4RBB	CMS5-4PPB	CMS5-4PBB
	5" (127mm)	6" (152mm)	4" (102mm)	CMS5-5BPN	CMS5-5BBN	-	-	CMS5-5RPB	CMS5-5RBB CMS5-5RBB-TB***	CMS5-5PPB	CMS5-5PBB

*Stainless steel yoke and brake
*** Top Brake

Regal Ride™ Medium Duty Threaded Stem Casters



MEDIUM DUTY THREADED STEM CASTERS



- FULL 1-1/4" (32mm) TREAD WIDTH • LOAD CAPACITY 250 lbs (110 kg) PER WHEEL
- CHOICE OF POLYOLEFIN, POLYURETHANE OR RUBBER WHEELS • BRAKE AND NON-BRAKE MODELS
- NON-MARRING GREASE RESISTANT POLYURETHANE TIRES FURNISHED WITH QUIET, EASY ROLLING WHEEL BEARINGS

STEM SIZE 1/2-13 X 1-1/2" LONG STEM

CASTER CONFIGURATION DATA			BLACK POLYOLEFIN WHEELS LOAD CAPACITY: 250 lbs (110 kg)		BLACK RUBBER WHEELS LOAD CAPACITY: 200 lbs (90 kg) *250 lbs (110 kg)		GRAY POLYURETHANE WHEELS FURNISHED WITH BALL BEARINGS LOAD CAPACITY: 250 lbs (110 kg)		DARK BLUE POLYURETHANE WHEELS FURNISHED WITH BALL BEARINGS LOAD CAPACITY: 250 lbs (110 kg)	
WHEEL DIA.	LOAD HEIGHT	SWIVEL RADIUS	NON-BRAKE MODEL NO.	BRAKE MODEL NO.	NON-BRAKE MODEL NO.	BRAKE MODEL NO.	NON-BRAKE MODEL NO.	BRAKE MODEL NO.	NON-BRAKE MODEL NO.	BRAKE MODEL NO.
3" (76mm)	4" (102mm)	2-7/8" (73mm)	CMT1-3BPN	CMT1-3BBN	CMT1-3KPN	CMT1-3KBN	-	-	CMT1-3PPB	CMT1-3PBB
4" (102mm)	5" (127mm)	3-3/8" (86mm)	CMT1-4BPN	CMT1-4BBN	CMT1-4KPN	CMT1-4KBN	CMT1-4RPB	CMT1-4RBB	CMT1-4PPB	CMT1-4PBB
5" (127mm)	6" (152mm)	4" (102mm)	CMT1-5BPN	CMT1-5BBN	*CMT1-5KPN	*CMT1-5KBN	CMT1-5RPB	CMT1-5RBB	CMT1-5PPB	CMT1-5PBB

STEM SIZE 5/8-11 X 1-1/2" LONG STEM

3" (76mm)	4" (102mm)	2-7/8" (73mm)	CMT2-3BPN	CMT2-3BBN	-	-	-	-	CMT2-3PPB	CMT2-3PBB
5" (127mm)	6" (152mm)	4" (102mm)	CMT2-5BPN	CMT2-5BBN	-	-	CMT2-5RPB	CMT2-5RBB	CMT2-5PPB	CMT2-5PBB

STEM SIZE 3/4-10 x 1" LONG STEM

3" (76mm)	4" (102mm)	2-7/8" (73mm)	-	CMT3-3BBN	-	-	-	-	-	-
5" (127mm)	6" (152mm)	4" (102mm)	CMT3-5BPN	CMT3-5BBN	-	-	-	-	-	-

STEM SIZE 1/2-13 X 1" LONG STEM

3" (76mm)	4" (102mm)	2-7/8" (73mm)	-	CMT4-3BBN	-	-	-	-	-	-
5" (127mm)	6" (152mm)	4" (102mm)	-	-	-	-	-	-	CMT4-5PPB	CMT4-5PBB

STEM SIZE 5/8-11 X 1" LONG STEM

5" (127mm)	6" (152mm)	4" (102mm)	CMT5-5BPN	CMT5-5BBN	-	-	CMT5-5RPB	CMT5-5RBB	CMT5-5PPB	CMT5-5PBB
------------	------------	------------	-----------	-----------	---	---	-----------	-----------	-----------	-----------

SPRING RING STEM

3" (76mm)	4" (102mm)	2-7/8" (73mm)	C99-1030	C99-1031	-	-	-	-	-	-
5" (127mm)	6" (152mm)	4" (102mm)	C99-1050	C99-1051	-	-	-	-	-	-



C11 SERIES STANDARD DUTY SWIVEL PLATE CASTERS

- LOAD CAPACITIES OF 125lbs, 150lbs AND 160 lbs (55 kg, 70 kg AND 75 kg) PER WHEEL SELECTED
- RUBBER OR POLYURETHANE TIRES WITH 1" (25mm) TREAD WIDTH
- BRAKE AND NON-BRAKE MODELS



COMPONENT

MOUNTING PLATE SIZE:*

1-3/4" x 3" (45mm x 76mm) WITH HOLE OPENINGS SPACED ON
1" x 2-1/4" (25mm x 57mm) CENTERS TO ACCEPT 1/4" (6mm) DIA. BOLTS

C11 SERIES STANDARD DUTY SWIVEL PLATE CASTERS

CASTER CONFIGURATION DATA			BLACK SOLID RUBBER TIRES LOAD CAPACITY: 125 lbs (55 kg)		GRAY RUBBER TIRES with POLY-LOC DISCS LOAD CAPACITY: 150 lbs (70 kg)		DARK BLUE POLYURETHANE TIRES WITH POLY-LOC DISCS LOAD CAPACITY: 160 lbs (75 kg)	
WHEEL DIA.	LOAD HEIGHT	SWIVEL RADIUS	NON-BRAKE MODEL NO.	BRAKE MODEL NO.	NON-BRAKE MODEL NO.	BRAKE MODEL NO.	NON-BRAKE MODEL NO.	BRAKE MODEL NO.
3" (76mm)	3-11/16" (95mm)	2-3/4" (70mm)	C11-1030	C11-1031	C11-2030	C11-2031	-	-
4" (102mm)	4-11/16" (120mm)	3-5/16" (85mm)	C11-1040	C11-1041	C11-2040	C11-2041	C11-3040	C11-3041
5" (127mm)	5-11/16" (145mm)	4" (102mm)	C11-1050	C11-1051	C11-2050	C11-2051	C11-3050	C11-3051

C11 SERIES LIGHT DUTY SWIVEL PLATE CASTER

NON-BRAKE MODEL NO.	WHEEL DIA.	LOAD HEIGHT	SWIVEL RADIUS	LOAD CAPACITY	TREAD WIDTH	WHEEL MATERIAL	MOUNTING PLATE SIZE:	MOUNTING HOLE SIZE	MOUNTING HOLE SPACING
C11-1020	2" (51mm)	2-1/2" (64mm)	1-7/8" (47mm)	80 lbs (35 kg)	13/16" (20mm)	GRAY RUBBER	1-3/16" x 2" (30mm x 51mm)	3/16" (5mm) DIA.	3/16" x 1-9/16" (5mm x 50mm) DIA.

*FOR PLATE HOLE PATTERN CONFIGURATION, REFER TO PG. B23.

Standard Duty Stem Casters



C13 SERIES STANDARD DUTY SWIVEL STEM CASTERS

- FOR 1", 1-1/4", 1-1/2", 1-5/8" & 2" (25mm, 32mm, 38mm, 40mm and 51mm) DIA. ROUND or SQUARE TUBING and 1-1/4" PIPE
- LOAD CAPACITIES OF 125, 150 and 160 lbs (55, 70 and 75 kg) PER WHEEL SELECTED
- RUBBER or POLYURETHANE TIRES with 1" (25mm) TREAD WIDTH
- BRAKE and NON-BRAKE MODELS



COMPONENT

C13 SERIES STANDARD DUTY SWIVEL STEM CASTERS

CASTER CONFIGURATION DATA				BLACK SOLID RUBBER TIRES LOAD CAPACITY: 125 lbs (55 kg)		GRAY RUBBER TIRES with POLY-LOC DISCS LOAD CAPACITY: 150 lbs (70 kg)		DARK BLUE POLYURETHANE TIRES WITH POLY-LOC DISCS LOAD CAPACITY: 160 lbs (75 kg)	
APPLICATION	WHEEL DIA.	LOAD HEIGHT	SWIVEL RADIUS	NON-BRAKE MODEL NO.	BRAKE MODEL NO.	NON-BRAKE MODEL NO.	BRAKE MODEL NO.	NON-BRAKE MODEL NO.	BRAKE MODEL NO.
1" (25mm) DIA. TUBING ROUND or SQUARE	4"	4-11/16"	3-5/16"	C13-1140	C13-1141	C13-2140	C13-2141	C13-3140	C13-3141
	5"	5-11/16"	4"	C13-1150	C13-1151	C13-2150	C13-2151	C13-3150	C13-3151
1-1/4" (30mm) DIA. TUBING ROUND or SQUARE	4"	4-11/16"	3-5/16"	C13-1240	C13-1241	C13-2240	C13-2241	C13-3240	C13-3241
	5"	5-11/16"	4"	C13-1250	C13-1251	C13-2250	C13-2251	C13-3250	C13-3251
1-1/2" (38mm) DIA. TUBING ROUND or SQUARE or 1-1/4" PIPE	3"	3-11/16"	2-3/4"	C13-1330	C13-1331	—	—	—	—
	4"	4-11/16"	3-5/16"	C13-1340	C13-1341	C13-2340	C13-2341	C13-3340	C13-3341
	5"	5-11/16"	4"	C13-1350	C13-1351	C13-2350	C13-2351	C13-3350	C13-3351
1-5/8" (40mm) DIA. TUBING ROUND or SQUARE	3"	3-11/16"	2-3/4"	C13-5430	C13-5431	—	—	—	—
	4"	4-11/16"	3-5/16"	C13-1440	C13-1441	C13-2440	C13-2441	C13-3440	C13-3441
	5"	5-11/16"	4"	C13-1450	C13-1451	C13-2450	C13-2451	C13-3450	C13-3451
2" (51mm) DIA. TUBING ROUND or SQUARE	4"	4-11/16"	3-5/16"	C13-1540	C13-1541	C13-2540	C13-2541	C13-3540	C13-3541
	5"	5-11/16"	4"	C13-1550	C13-1551	C13-2550	C13-2551	C13-3550	C13-3551



C21 SERIES MEDIUM DUTY SWIVEL AND RIGID PLATE CASTERS

- LOAD CAPACITIES OF 155, 200, 250 AND 300 lbs (70, 90, 115 and 135 kg) PER WHEEL SELECTED
- RUBBER OR POLYURETHANE TIRES WITH 1-1/4" (32mm) TREAD WIDTH
- BRAKE AND NON-BRAKE MODELS

MOUNTING PLATE SIZE:*

2-3/8" x 3-5/8" (60mm x 92mm) WITH HOLE OPENINGS SPACED ON 1-3/4" x 3" (45mm x 75mm) CENTERS TO ACCEPT 1/4" or 5/16" (6mm or 8mm) DIA. BOLTS



COMPONENT

C21 SERIES MEDIUM DUTY SWIVEL PLATE CASTERS									
CASTER CONFIGURATION DATA			BLACK SOLID RUBBER TIRES LOAD CAPACITY: 155 lbs (70 kg) *200 lbs (90 kg)		GRAY RUBBER TIRES with POLY-LOC DISCS LOAD CAPACITY: 155 lbs (70 kg) *200 lbs (90 kg)		DARK BLUE POLYURETHANE TIRES WITH POLY-LOC DISCS LOAD CAPACITY: 250 lbs (110 kg) *300 lbs (135 kg)		
WHEEL DIA.	LOAD HEIGHT	SWIVEL RADIUS	NON-BRAKE MODEL NO.	BRAKE MODEL NO.	NON-BRAKE MODEL NO.	BRAKE MODEL NO.	NON-BRAKE MODEL NO.	BRAKE MODEL NO.	
3-1/2" (89mm)	4-1/2" (115mm)	3-5/16" (85mm)	*C21-1035	*C21-1036	C21-2035	C21-2036	C21-3035	C21-3036	
4" (102mm)	5" (127mm)	3-3/8" (86mm)	-	-	-	-	C21-3040	C21-3041	
5" (127mm)	6-1/8" (155mm)	4" (102mm)	*C21-1050	*C21-1051	*C21-2050	*C21-2051	*C21-3050	*C21-3051	
C21 SERIES MEDIUM DUTY RIGID PLATE CASTERS									
3-1/2" (89mm)	4-1/2" (115mm)	3-5/16" (85mm)	*C21-1035-R	-	C21-2035-R	-	-	-	
5" (127mm)	6-1/8" (155mm)	4" (102mm)	*C21-1050-R	-	*C21-2050-R	-	-	-	

*FOR PLATE HOLE PATTERN CONFIGURATION, REFER TO PG. B23.

Medium Duty Stem Casters



C23 SERIES MEDIUM DUTY SWIVEL and RIGID STEM CASTERS

- FOR 1", 1-1/4", 1-1/2", 1-5/8" & 2" (25, 32, 38, 40 & 51mm) DIA. ROUND OR SQUARE TUBING AND 1-1/4" PIPE
- LOAD CAPACITIES OF 155, 200, 250 AND 300 lbs (70, 90, 115 AND 135 kg) PER WHEEL SELECTED
- RUBBER OR POLYURETHANE TIRES WITH 1-1/4" (32mm) TREAD WIDTH • BRAKE and NON-BRAKE MODELS

C23 SERIES MEDIUM DUTY SWIVEL STEM CASTERS

CASTER CONFIGURATION DATA				BLACK SOLID RUBBER TIRES LOAD CAPACITY: 155 lbs (70 kg) *200 lbs (90 kg)		GRAY RUBBER TIRES with POLY-LOC DISCS LOAD CAPACITY: 150 lbs (68 kg) *200 lbs (90 kg)		DARK BLUE POLYURETHANE TIRES WITH POLY-LOC DISCS LOAD CAPACITY: 250 lbs (110 kg) *300 lbs (135 kg)	
APPLICATION	WHEEL DIA.	LOAD HEIGHT	SWIVEL RADIUS	NON-BRAKE MODEL NO.	BRAKE MODEL NO.	NON-BRAKE MODEL NO.	BRAKE MODEL NO.	NON-BRAKE MODEL NO.	BRAKE MODEL NO.
1" (25mm) DIA. TUBING ROUND or SQUARE	3-1/2" (89mm)	4-1/2" (114mm)	3-1/4" (83mm)	*C23-1135	*C23-1136	C23-2135	C23-2136	C23-3135	C23-3136
	5" (127mm)	6-1/8" (160mm)	4" (102mm)	*C23-1150	*C23-1151	*C23-2150	*C23-2151	*C23-3150	*C23-3151
1-1/4" (32mm) DIA. TUBING ROUND or SQUARE	3-1/2" (89mm)	4-1/2" (114mm)	3-1/4" (83mm)	*C23-1235	*C23-1236	C23-2235	C23-2236	C23-3235	C23-3236
	5" (127mm)	6-1/8" (160mm)	4" (102mm)	*C23-1250	*C23-1251	*C23-2250	*C23-2251	*C23-3250	*C23-3251
1-1/2" (38mm) DIA. TUBING ROUND or SQUARE or 1-1/4" PIPE	3-1/2" (89mm)	4-1/2" (114mm)	3-1/4" (83mm)	*C23-1335	*C23-1336	C23-2335	C23-2336	C23-3335	C23-3336
	5" (127mm)	6-1/8" (160mm)	4" (102mm)	*C23-1350	*C23-1351	*C23-2350	*C23-2351	*C23-3350	*C23-3351
1-5/8" (40mm) DIA. TUBING ROUND or SQUARE	3-1/2" (89mm)	4-1/2" (114mm)	3-1/4" (83mm)	*C23-1435	*C23-1436	C23-2435	C23-2436	C23-3435	C23-3436
	5" (127mm)	6-1/8" (160mm)	4" (102mm)	*C23-1450	*C23-1451	*C23-2450	*C23-2451	*C23-3450	*C23-3451
	6" (152mm)	7-1/8" (180mm)	4-1/2" (114mm)	-	-	-	-	*C23-3460	*C23-3461
2" (51mm) DIA. TUBING ROUND or SQUARE	3-1/2" (89mm)	4-1/2" (114mm)	3-1/4" (83mm)	*C23-1535	*C23-1536	C23-2535	C23-2536	C23-3535	C23-3536
	5" (127mm)	6-1/8" (160mm)	4" (102mm)	C23-1550	C23-1551	C23-2550	C23-2551	*C23-3550	*C23-3551
	6" (152mm)	7-1/8" (180mm)	4-1/2" (114mm)	-	-	-	-	*C23-3560	*C23-3561

C23 SERIES MEDIUM DUTY RIGID STEM CASTERS

1" (25mm) DIA. TUBING ROUND or SQUARE	5" (127mm)	6-1/8" (160mm)	4" (102mm)	*C23-1150-R	-	-	-	-	-
1-1/4" (32mm) DIA. TUBING ROUND or SQUARE	5" (127mm)	6-1/8" (160mm)	4" (102mm)	-	-	*C23-2250-R	-	-	-
1-1/2" (38mm) DIA. TUBING ROUND or SQUARE or 1-1/4" PIPE	5" (127mm)	6-1/8" (160mm)	4" (102mm)	*C23-1350-R	-	-	-	-	-
1-5/8" (40mm) DIA. TUBING ROUND or SQUARE	5" (127mm)	6-1/8" (160mm)	4" (102mm)	*C23-1450-R	-	*C23-2450-R	-	-	-



COMPONENT



C21-SS SERIES MEDIUM DUTY STAINLESS STEEL SWIVEL PLATE CASTERS

- LOAD CAPACITY OF 200 lbs (90 kg) PER CASTER • POLY-LOCWHEELS WITH 1-1/4" (32mm) TREAD WIDTH
- COMPLETE WITH ZERK GREASE FITTINGS AND SEALS • BRAKE AND NON-BRAKE MODELS

MOUNTING PLATE SIZE:	
2-3/8" x 3-5/8" (60mm x 92mm) WITH HOLE OPENINGS SPACED ON 1-3/4" x 3" (45mm x 76mm) CENTERS TO ACCEPT 1/4" or 5/16" (6mm or 8mm) DIA. BOLTS	

STAINLESS STEEL MEDIUM DUTY SWIVEL PLATE CASTERS				
CASTER CONFIGURATION DATA			GRAY POLYURETHANE POLY-LOC WHEELS LOAD CAPACITY: 200 lbs (90 kg)	
WHEEL DIA.	LOAD HEIGHT	SWIVEL RADIUS	NON-BRAKE MODEL NO.	BRAKE MODEL NO.
5" (127mm)	6-1/8" (155mm)	4-5/16" (110mm)	C21-2050-SS	C21-2051-SS

C23-SS SERIES MEDIUM DUTY STAINLESS STEEL SWIVEL STEM CASTERS

- FOR 1", 1-1/4", 1-1/2", 1-5/8" & 2" (25mm, 32mm, 38mm, 40mm & 51mm) DIA. ROUND OR SQUARE TUBING AND 1-1/4" PIPE
- LOAD CAPACITY OF 200 lbs (90 kg) PER CASTER • POLY-LOC WHEELS WITH 1-1/4" (32mm) TREAD WIDTH
- COMPLETE WITH ZERK GREASE FITTINGS AND SEALS • BRAKE AND NON-BRAKE MODELS

STAINLESS STEEL MEDIUM DUTY SWIVEL STEM CASTERS							
CASTER CONFIGURATION DATA				GRAY POLYURETHANE POLY-LOC WHEELS LOAD CAPACITY: 200 lbs (90 kg)		DARK BLUE POLYURETHANE POLY-LOC WHEELS LOAD CAPACITY: 200 lbs (90 kg)	
APPLICATION	WHEEL DIA.	LOAD HEIGHT	SWIVEL RADIUS	NON-BRAKE MODEL NO.	BRAKE MODEL NO.	NON-BRAKE MODEL NO.	BRAKE MODEL NO.
1" (25mm DIA. TUBING ROUND OR SQUARE)	5" (127mm)	6-1/8" (160mm)	4" (102mm)	C23-2150-SS	C23-2151-SS	-	-
1-1/4" (32mm) DIA. TUBING ROUND OR SQUARE	5" (127mm)	6-1/8" (160mm)	4" (102mm)	C23-2250-SS	C23-2251-SS	-	-
1-1/2" (38mm) DIA. TUBING ROUND OR SQUARE OR 1-1/4" PIPE	5" (127mm)	6-1/8" (160mm)	4" (102mm)	C23-2350-SS	C23-2351-SS	-	-
1-5/8" (40mm) DIA. TUBING ROUND OR SQUARE	5" (127mm)	6-1/8" (160mm)	4" (102mm)	C23-2450-SS	C23-2451-SS	-	-
2" (51mm) DIA. TUBING ROUND OR SQUARE	5" (127mm)	6-1/8" (160mm)	4" (102mm)	C23-2550-SS	C23-2551-SS	-	-
1" (25mm DIA. TUBING ROUND OR SQUARE)	5" (127mm)	6-1/8" (160mm)	4" (102mm)	-	-	C23-3150-SS	C23-3151-SS

Threaded Stem & Plate Casters

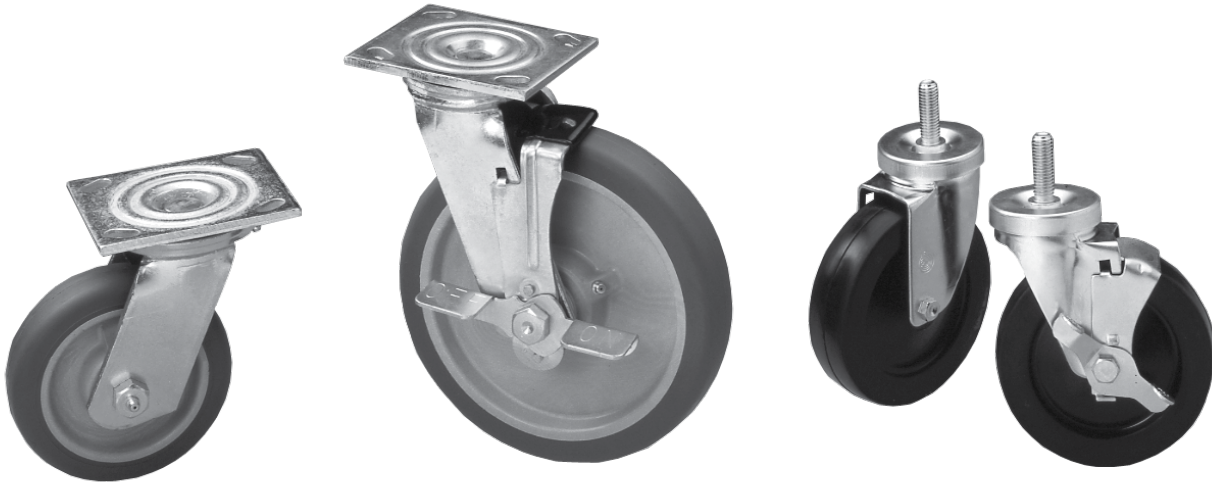

C31 SERIES HEAVY DUTY SWIVEL PLATE CASTERS

- LOAD CAPACITIES
500 lbs (225 kg) PER CASTER
- GRAY POLYURETHANE POLY-LOC WHEELS
WITH 1-1/2" (38mm) TREAD WIDTH
- SUPPLIED WITH ZERK GREASE FITTINGS AND SEALS
- BRAKE AND NON-BRAKE MODELS

MOUNTING PLATE SIZE:

4" x 4-1/2" (102mm x 114mm)
WITH SLOTTED OPENINGS SPACED ON
2-3/4" x 3-1/4" (70mm x 64mm) CENTERS
TO ACCEPT 1/4" (6mm) DIA. BOLTS

C31 SERIES HEAVY DUTY SWIVEL PLATE CASTERS

CASTER CONFIGURATION DATA			GRAY POLYURETHANE POLY-LOC WHEELS LOAD CAPACITY: 500 lbs (225 kg)	
WHEEL DIA.	LOAD HEIGHT	SWIVEL RADIUS	NON-BRAKE MODEL NO.	BRAKE MODEL NO.
5" (127mm)	6-1/2" (165mm)	4-5/16" (110mm)	C31-2050	C31-2051
6" (152mm)	7-1/2" (191mm)	5-1/16" (130mm)	C31-2060	C31-2061
8" (204mm)	9-1/2" (241mm)	6-1/2" (165mm)	C31-2080	C31-2081

NOTE: RIGID PLATE CASTERS AVAILABLE AS
NON-STOCK ITEMS FOR ALL NON-BRAKE MODELS.
SEE PAGES B4 FOR CASTER SPECIALTIES AND ACCESSORIES.



C25 SERIES MEDIUM DUTY THREADED SWIVEL STEM CASTERS

- LOAD CAPACITIES
200 lbs (90 kg) PER CASTER
- SOLID RUBBER WHEELS
WITH 1-1/4" (32mm) TREAD WIDTH
- BRAKE AND NON-BRAKE MODELS

1/2-13 X 1-1/2" LONG STEM

CASTER CONFIGURATION DATA			BLACK SOLID RUBBER TIRES LOAD CAPACITY: 200 lbs (90 kg)	
WHEEL DIA.	LOAD HEIGHT	SWIVEL RADIUS	NON-BRAKE MODEL NO.	BRAKE MODEL NO.
5" (127mm)	6-1/2" (165mm)	4-5/16" (110mm)	C25-1950	C25-1951

5/8-11 x 1-1/4" LONG STEM

3" (76mm)	3-11/16" (95mm)	2-3/4" (70mm)	C25-1000	C25-1001
--------------	--------------------	------------------	----------	----------

NOTE: RIGID NON-BRAKE MODEL AVAILABLE AS A NON-STOCK ITEM.
SEE PAGES B4 FOR CASTER SPECIALTIES AND ACCESSORIES.



LIGHT DUTY THREADED SWIVEL STEM UTILITY CASTER MODEL NO. C15-1820

LOAD CAPACITY: 80 lbs (35 kg)

WHEEL MATERIAL: SOLID BLACK RUBBER

LOAD HEIGHT: 2-1/2" (64mm)

THREADED WIDTH: 13/16" (20mm)

WHEEL DIAMETER: 2" (51mm)

SWIVEL RADIUS: 1-7/8" (47mm)

THREADED STEM SIZE: 3/8"-16 x 1-1/2" (38mm) Lg.

Adjustable Caster Leg Assemblies

- 1-5/8" (41mm) AND 2" (51mm) O.D. STAINLESS STEEL LEGS WITH WELDED MOUNTING PLATES OR PROTRUDING STUDS
- MEDIUM DUTY CASTERS WITH 3", 4" AND 5" (76, 102 AND 127mm) DIA. POLYOLEFIN* WHEELS
- BRAKE AND NON-BRAKE MODELS
- SUPPLIED WITH SLOTTED HEAD LOCKING SET SCREWS TO MEET N.S.F. REQUIREMENTS



SAFETY SERIES ADJUSTABLE CASTER LEG ASSEMBLIES



COMPONENT

SAFETY SERIES CASTER LEG ASSEMBLIES were designed specifically for fryers and other "hot content" equipment that rests on pitched floors and must be moved for cleaning and servicing. To avoid dangerous content spillage, these casters are engineered with a SPECIAL RETAINING FEATURE...the caster CANNOT BE DISASSEMBLED FROM THE LEG while adjusting equipment height or during the movement of equipment. Eliminates incidence of costly spills and serious accidents from caster assemblies inadvertently coming apart.

SAFETY SERIES 1-5/8" (41mm) O.D. CASTER LEG ASSEMBLIES

WHEEL DIA.	MOUNTING TYPE	MINIMUM O.A. HEIGHT	ADJ.	NON-BRAKE MODEL NO.	BRAKE MODEL NO.	LOAD RATING PER CASTER
3" (76mm)		6" (152mm)	1/2" (12mm)	C47-0306-C	C47-0316-C	200 lbs (90 kg)
4" (102mm)	3-1/2" (89mm) SQUARE PLATE*	7-1/2" (190mm)	1" (25mm)	C47-0406-C	C47-0416-C	275 lbs (125 kg)
5" (127mm)		8-1/2" (215mm)	1" (25mm)	C47-0506	C47-0516	300 lbs (135 kg)
4" (102mm)	1/2-13 STUD	7-1/2" (190mm)	1" (25mm)	C50-0406-C	C50-0416-C	275 lbs (125 kg)
5" (127mm)		8-1/2" (215mm)	1" (25mm)	C50-0506-C	C50-0516-C	300 lbs (135 kg)
3" (76mm)	3-1/2" (89mm) SQUARE PLATE*	8-1/2" (215mm)	2" (50mm)		C48-03185-C	300 lbs (135 kg)

*Universal mounting plate – for plate hole pattern configuration, refer to pg. B23.

SAFETY SERIES 2" (51mm) O.D. CASTER LEG ASSEMBLIES

WHEEL DIA.	MOUNTING TYPE	MINIMUM O.A. HEIGHT	ADJ.	NON-BRAKE MODEL NO.	BRAKE MODEL NO.	LOAD RATING PER CASTER
5" (127mm)	3-1/2" (89mm) SQUARE PLATE	8-1/2" (215mm)	1" (25mm)	C83-0506	C83-0516	300 lbs (135 kg)
5" (127mm)	3/4-10 STUD	8-1/2" (215mm)	1" (25mm)	C86-0506	C86-0516-C	300 lbs (135 kg)

*Solid Polyolefin Wheels are lightweight, easy rolling wheels made from one of the most durable thermoplastics. These wheels require no bearings and are ideal for those corrosive conditions which cause costly and continual bearing replacement. Polyolefin wheels offer resistance to most oils, chemicals, grease, solvents and acids.

SPECIFICATIONS

LEGS: 16 ga (2mm), POLISHED TO A #4 SATIN FINISH AND FURNISHED WITH (2) LOCKING SLOTTED HEAD SET SCREWS (TO CONFORM TO NSF REQUIREMENTS).

MOUNTING PLATES: 11 ga (3mm) PAINTED STEEL, 3-1/2" (89mm) SQUARE WITH FOUR 5/16" (8mm) DIA. HOLES ON 2-5/8" (66mm) CENTERS.

CASTERS: MEDIUM DUTY WITH *POLYOLEFIN WHEELS WITH A TREAD WIDTH OF 1-1/4" (32mm) AND AN OPERATING TEMPERATURE RANGE OF -20°F TO 180°F (-29°C TO 82°C). HARDNESS OF 65+ 5 DUROMETER ON SHORE D SCALE.

CASTER LEG ASSEMBLIES ARE NON-STOCK ITEMS. OTHER MODELS AVAILABLE ON SPECIAL APPLICATION.

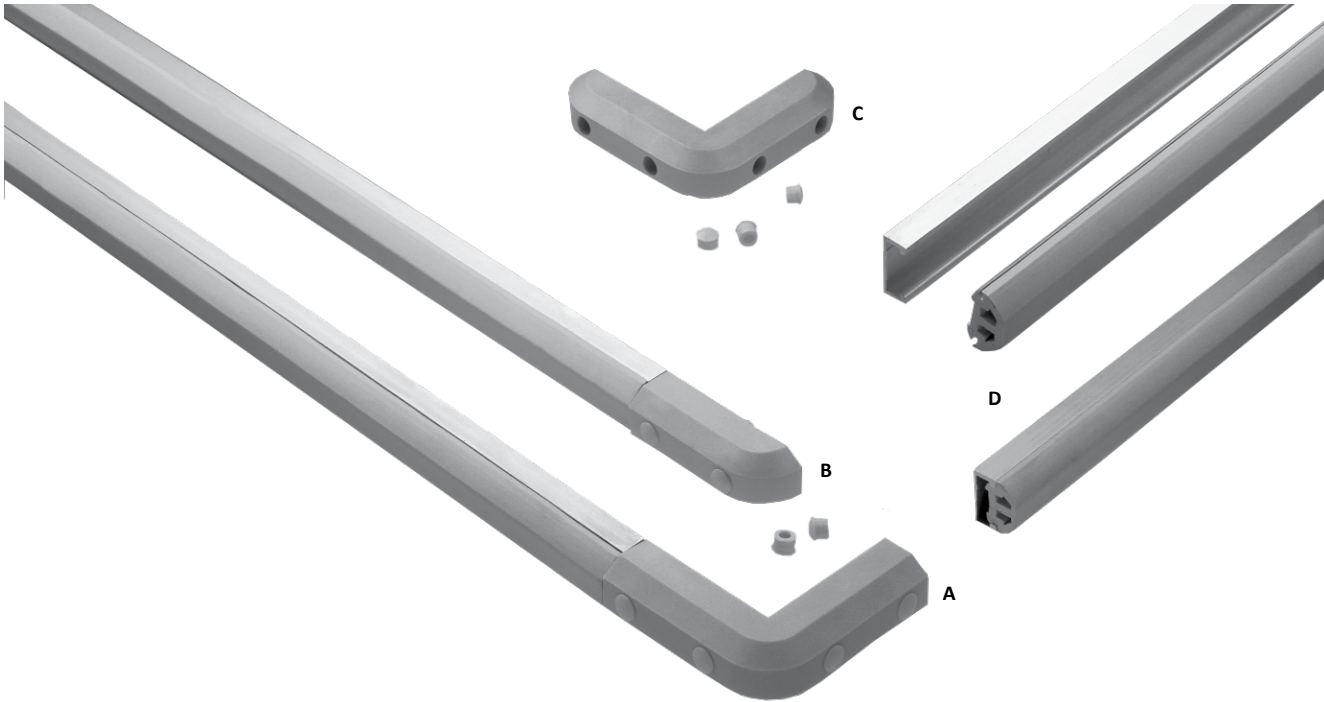

CONTEMPO STRIP BUMPER SYSTEM

- CONCEALED MOUNTING... MAY BE RIVETED OR FASTENED WITH SCREWS
- TWO PIECE CONSTRUCTION... EXTRUDED ANODIZED ALUMINUM BASE WITH A DURABLE CUSHION STRIP THAT EASILY SNAPS IN PLACE
- SPECIAL CORNERS AND ENDS INTERFACE WITH STRIP BUMPER TO PROVIDE A CONTINUOUS, UNIFORM, ONE PIECE APPEARANCE



REF. A

CORNER INTERFACE MODEL NO. C65-5090

MATERIAL: GRAY PVC
FURNISHED WITH HOLE PLUGS

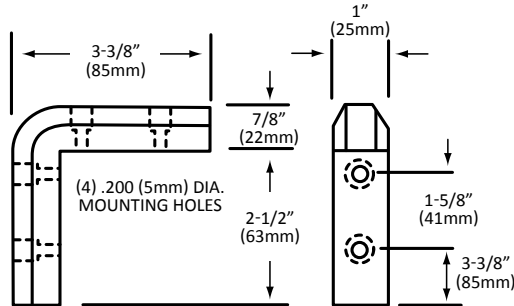

REF. B

END CAP INTERFACE MODEL NO. C65-5000

MATERIAL: GRAY PVC
FURNISHED WITH HOLE PLUGS

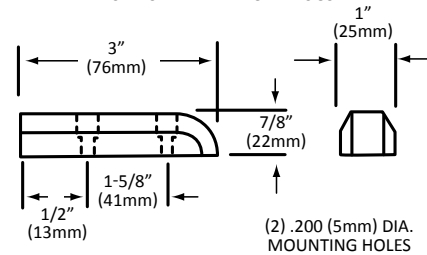

REF. C

CORNER BUMPER MODEL NO. C65-1010

MATERIAL: GRAY PVC
FURNISHED WITH HOLE PLUGS

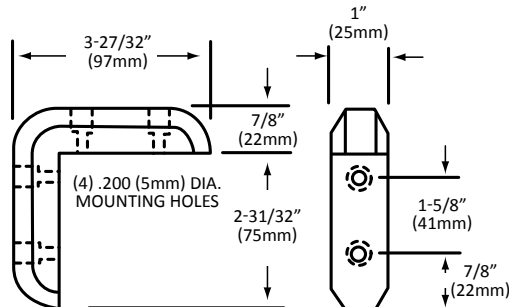

REF. D

STRAIGHT STRIP BUMPER MODEL NO. C65-2072

72" (1829mm) LG.

MODEL NO. C65-2120

120" (3048mm) LG.

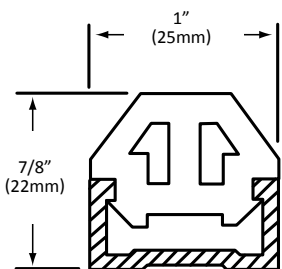

MATERIAL: EXTRUDED ALUMINUM RAIL
WITH GRAY PVC SNAP-ON BUMPER STRIP

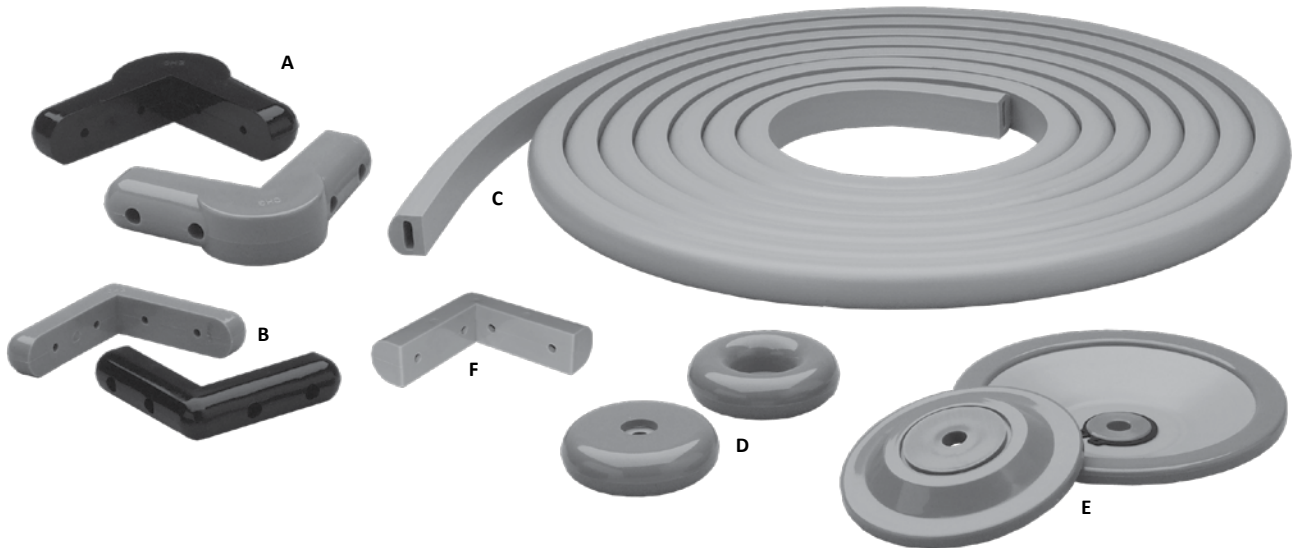

STANDARD BUMPER COMPONENTS

REF. A

CORNER BUMPER WITH ROUNDED ENDS & CORNER

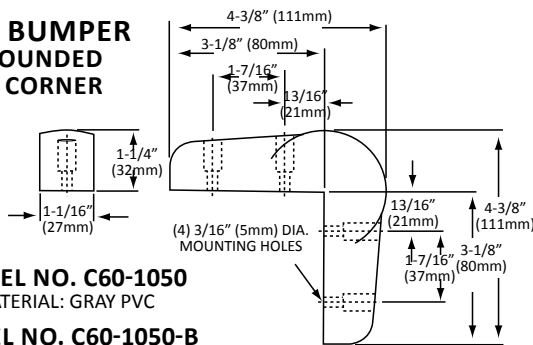

MODEL NO. C60-1050
MATERIAL: GRAY PVC

MODEL NO. C60-1050-B
MATERIAL: BLACK PVC

HOLE PLUGS
MODEL NO. C60-X100-B

REF. B

CORNER BUMPER WITH ROUND ENDS

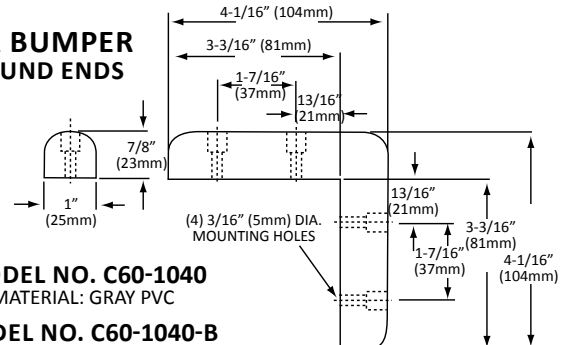

MODEL NO. C60-1040
MATERIAL: GRAY PVC

MODEL NO. C60-1040-B
MATERIAL: BLACK PVC

HOLE PLUGS
MODEL NO. C60-X100-B

REF. C

STRIP BUMPER

MODEL NO. C60-5010
MATERIAL: GRAY RUBBER

FURNISHED IN
25 ft. (7.6m) COILS

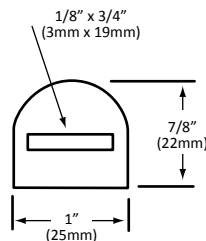

REF. D

ROUND BUMPER

MODEL NO. C60-1020
MATERIAL: GRAY RUBBER, STEEL REINFORCED.

IDEAL FOR USE ON
ENDS OF TUBULAR
HANDLES.

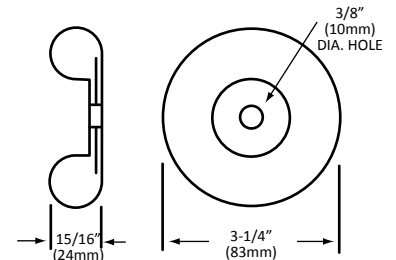

REF. E

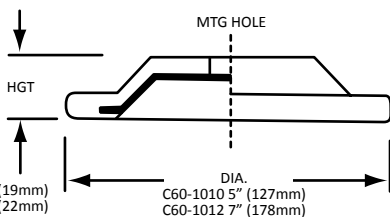

C60-1010 3/4" (19mm)
C60-1012 7/8" (22mm)

C60-1010 5" (127mm)
C60-1012 7" (178mm)

ROLLING BUMPER

MODEL NO. C60-1010 1/2" (13MM) MTG. HOLE

MODEL NO. C60-1012 1/2" (13MM) MTG. HOLE

MODEL NO. C60-1010-SR 0.846" (21MM) MTG. HOLE

FITS: STANDARD AND MEDIUM DUTY CASTERS
MATERIAL: GRAY RUBBER, STEEL REINFORCED

ROLLING BUMPER WHEELS MAY BE SUPPLIED FOR ANY
STOCK DIAMETER STEM WITH RUBBER EXPANDING APPLICATORS

REF. F

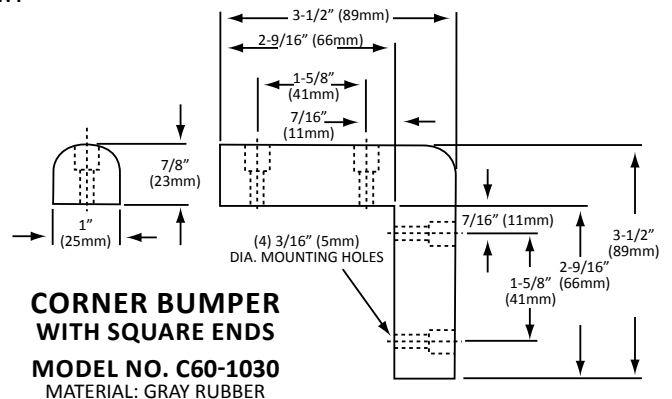

CORNER BUMPER WITH SQUARE ENDS

MODEL NO. C60-1030
MATERIAL: GRAY RUBBER

Mounting Plate Hole Pattern Configurator

CMP1 SERIES MOUNTING PLATE

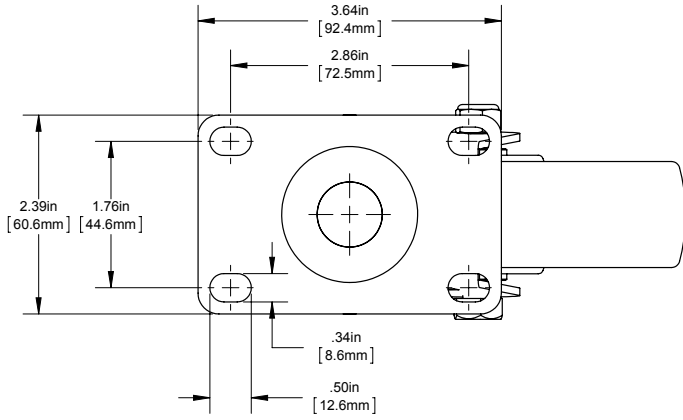

CLP2 SERIES MOUNTING PLATE

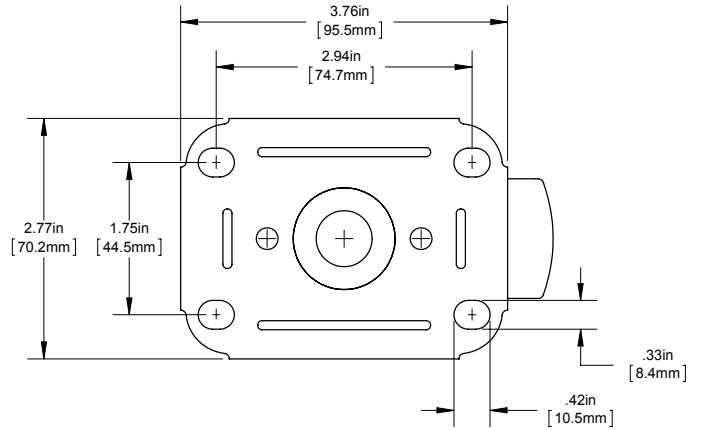

CMP4 SERIES MOUNTING PLATE

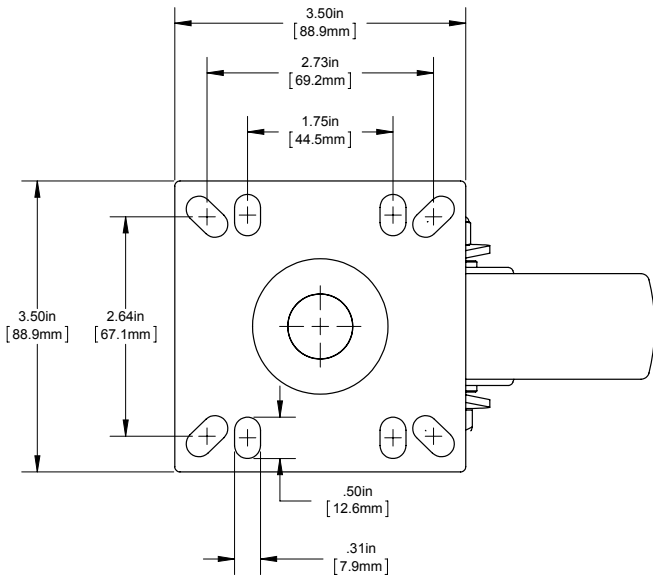

CMPU SERIES MOUNTING PLATE

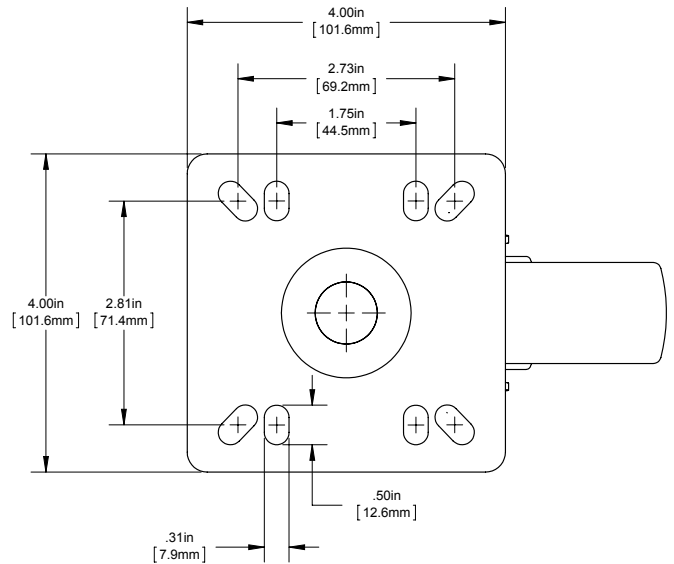

Mounting Plate Hole Pattern Configurator

C11 LIGHT DUTY SERIES MOUNTING PLATE

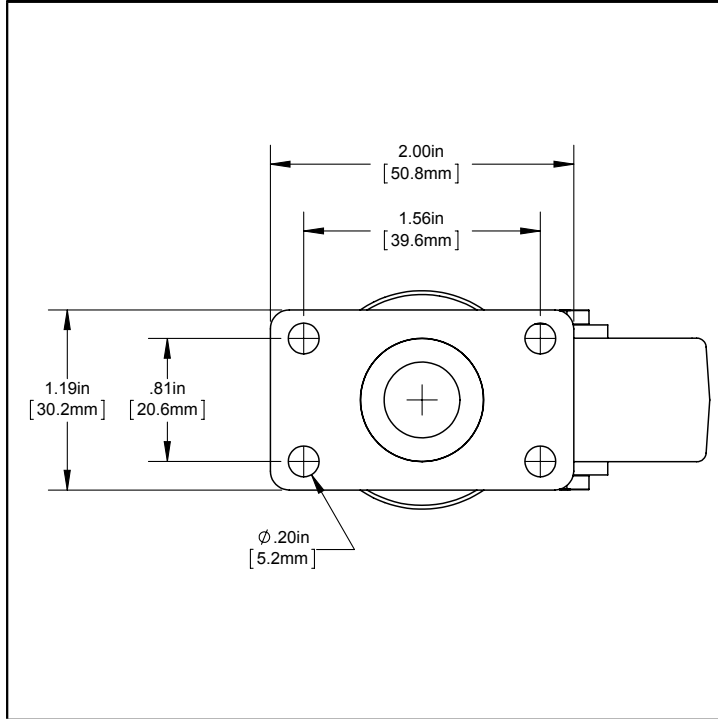

C11 SERIES MOUNTING PLATE

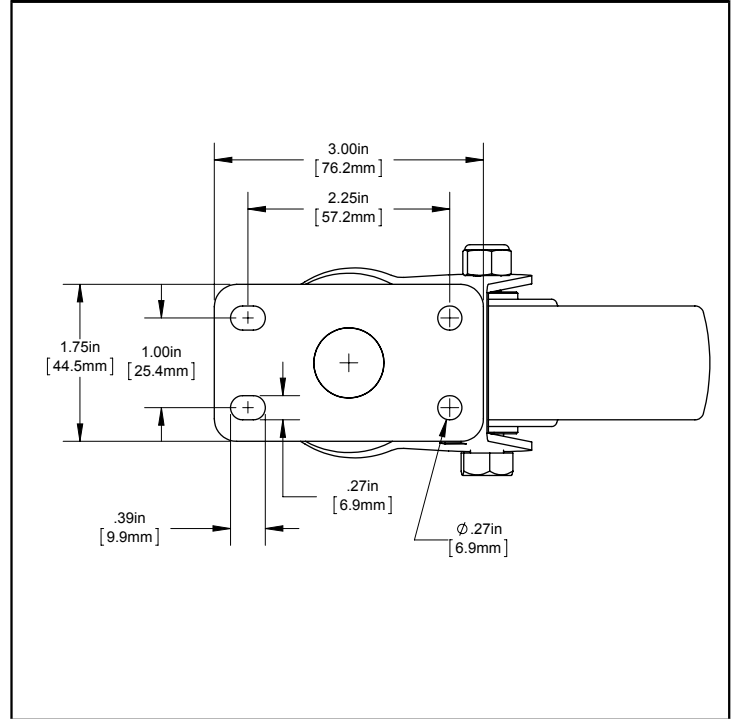

C21 SERIES MOUNTING PLATE

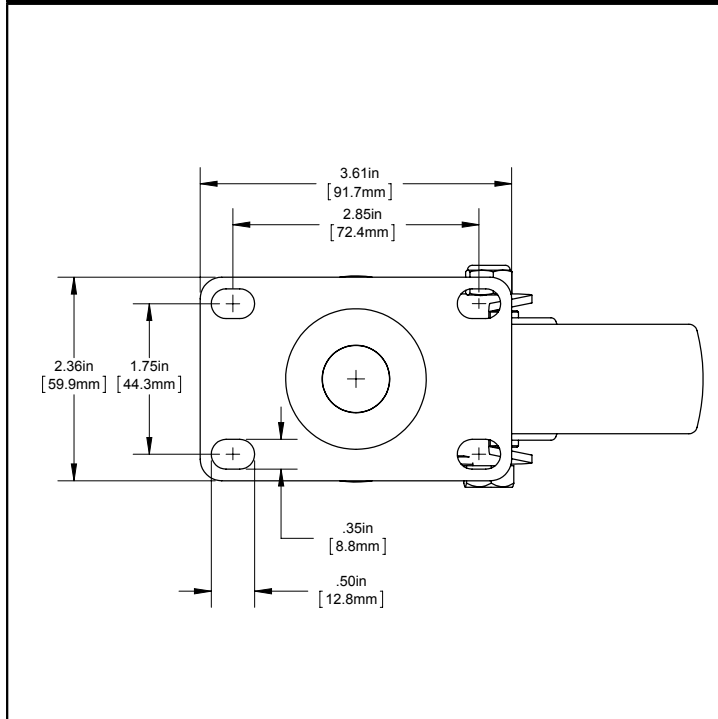

C47 SERIES MOUNTING PLATE

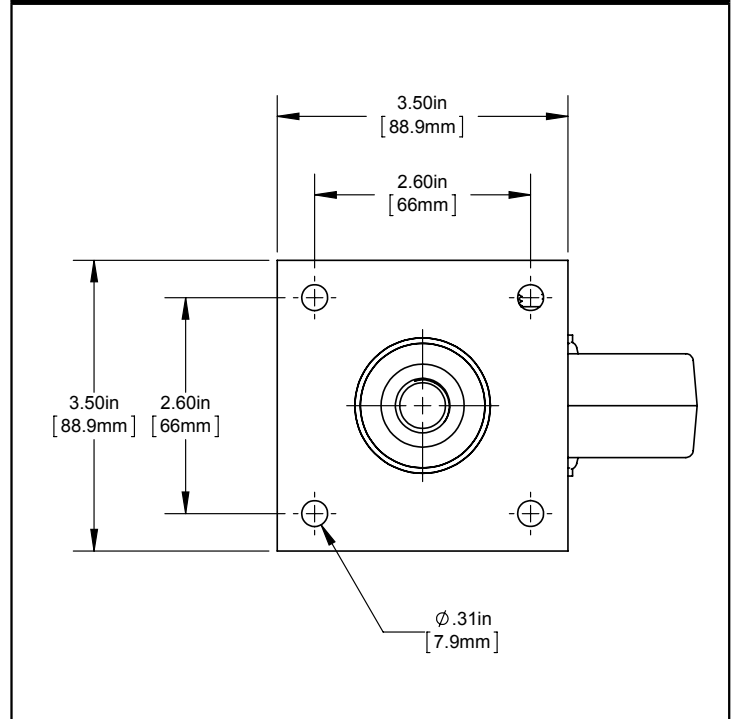

Mounting Plate Hole Pattern Configurator

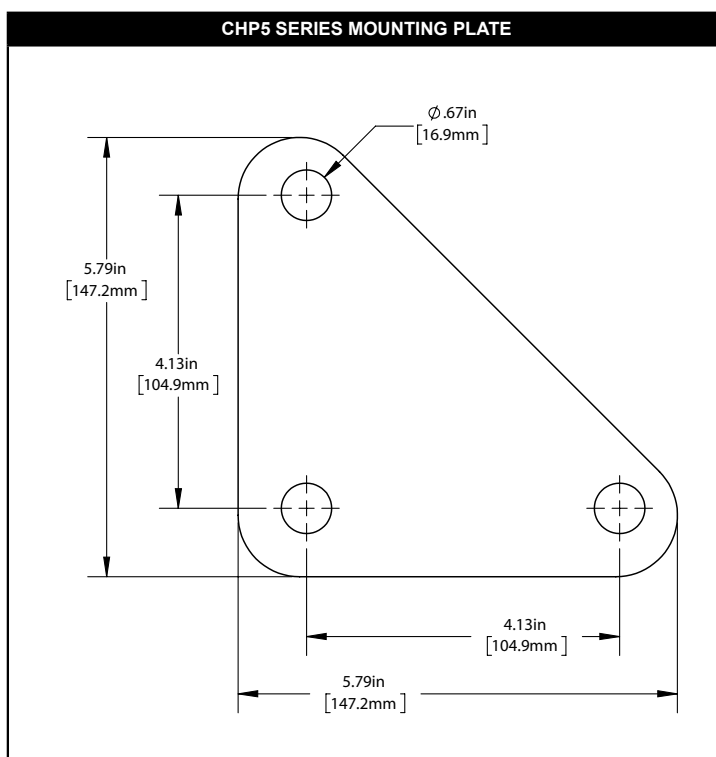
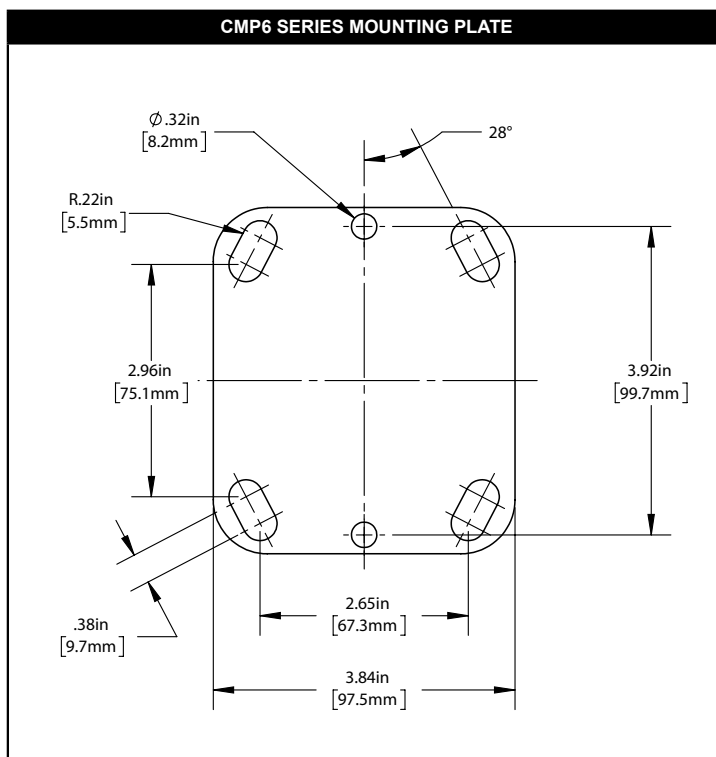

REGAL RIDE CASTER CONFIGURATOR

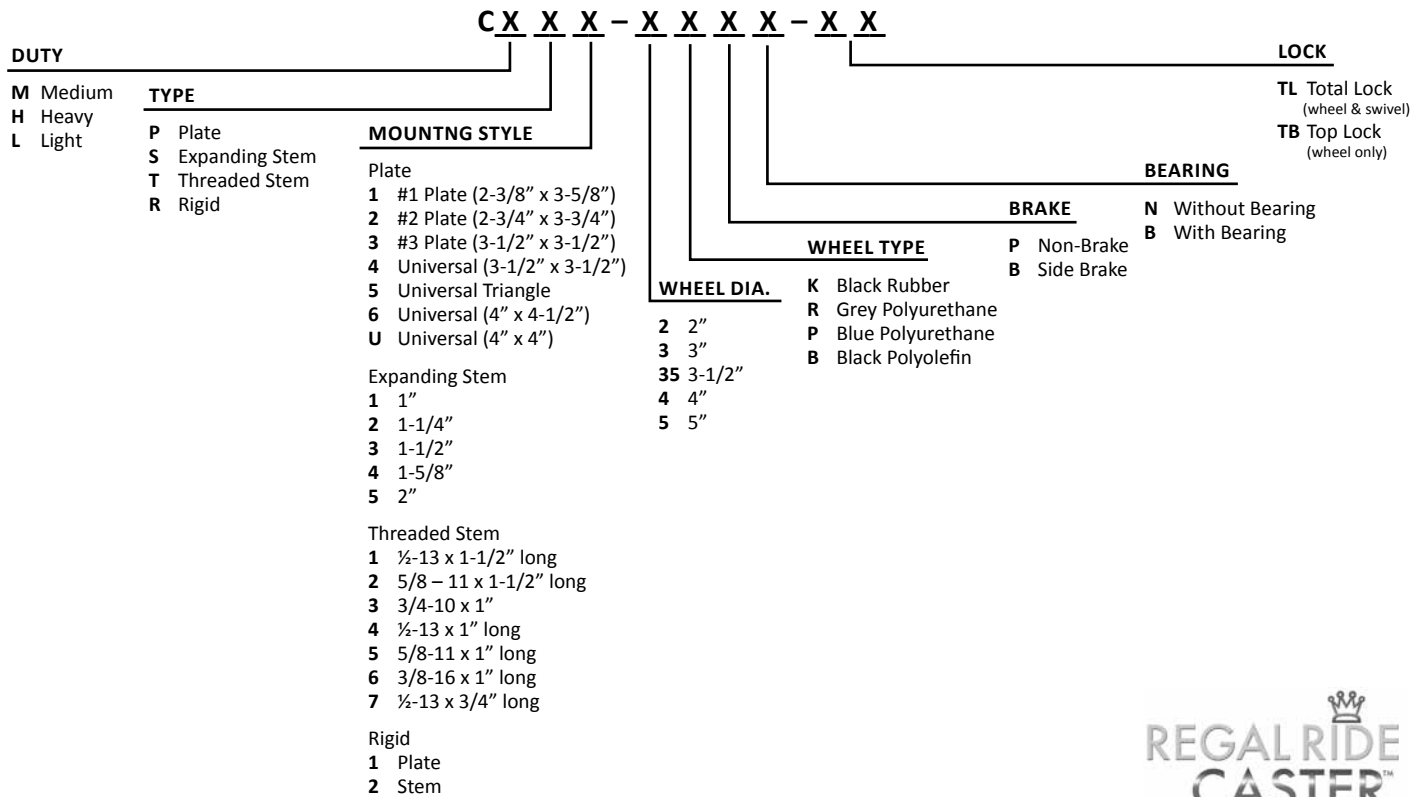

Index

MODEL NO.	PAGE NO.	MODEL NO.	PAGE NO.	MODEL NO.	PAGE NO.	MODEL NO.	PAGE NO.	MODEL NO.	PAGE NO.
C11-1020	B11	C13-3341	B12	C23-2251	B14	C60-1010	B19	CMR1-4KPN	B7
C11-1030	B11	C13-3350	B12	C23-2251-SS	B15	C60-1010-SR	B19	CMR1-4PPB	B7
C11-1031	B11	C13-3351	B12	C23-2335	B14	C60-1012	B19	CMR1-4RPB	B7
C11-1040	B11	C13-3440	B12	C23-2336	B14	C60-1020	B19	CMR1-5BPN	B7
C11-1041	B11	C13-3441	B12	C23-2350	B14	C60-1030	B19	CMR1-5KPN	B7
C11-1050	B11	C13-3450	B12	C23-2350-SS	B15	C60-1040	B19	CMR1-5PPB	B7
C11-1051	B11	C13-3451	B12	C23-2351	B14	C60-1040-B	B19	CMR1-5RPB	B7
C11-2030	B11	C13-3540	B12	C23-2351-SS	B15	C60-1050	B19	CMS1-35KBN	B8
C11-2031	B11	C13-3541	B12	C23-2435	B14	C60-1050-B	B19	CMS1-35KPN	B8
C11-2040	B11	C13-3550	B12	C23-2436	B14	C60-5010	B19	CMS1-3BBN	B9
C11-2041	B11	C13-3551	B12	C23-2450	B14	C60-X100-B	B19	CMS1-3BPN	B9
C11-2050	B11	C13-5430	B12	C23-2450-R	B14	C65-1010	B18	CMS1-3PBB	B9
C11-2051	B11	C13-5431	B12	C23-2450-SS	B15	C65-2072	B18	CMS1-3PPB	B9
C11-3040	B11	C15-1820	B16	C23-2451	B14	C65-2120	B18	CMS1-35KBN	B8
C11-3041	B11	C21-1035	B13	C23-2451-SS	B15	C65-5000	B18	CMS1-35KPN	B8
C11-3050	B11	C21-1035-R	B13	C23-2535	B14	C65-5090	B18	CMS1-4BBN	B9
C11-3051	B11	C21-1036	B13	C23-2536	B14	C83-0506	B17	CMS1-4BPN	B9
C13-1140	B12	C21-1050	B13	C23-2550	B14	C83-0516	B17	CMS1-4KBN	B9
C13-1141	B12	C21-1050-R	B13	C23-2550-SS	B15	C86-0506	B17	CMS1-4PBB	B9
C13-1150	B12	C21-1051	B13	C23-2551	B14	C86-0516-C	B17	CMS1-4PPB	B9
C13-1151	B12	C21-2035	B13	C23-2551-SS	B15	C99-1030	B10	CMS1-4RBB	B9
C13-1240	B12	C21-2035-R	B13	C23-3135	B14	C99-1031	B10	CMS1-4RPB	B9
C13-1241	B12	C21-2036	B13	C23-3136	B14	C99-1050	B10	CMS1-5BBN	B9
C13-1250	B12	C21-2050	B13	C23-3150	B14	C99-1051	B10	CMS1-5BPN	B9
C13-1251	B12	C21-2050-R	B13	C23-3150-SS	B15	CLP2-3BBN	B7	CMS1-5KBN	B9
C13-1330	B12	C21-2050-SS	B15	C23-3151	B14	CLP2-3BPN	B7	CMS1-5KPN	B9
C13-1331	B12	C21-2051	B13	C23-3151-SS	B15	CMP1-35KBN	B7	CMS1-5PBB	B9
C13-1340	B12	C21-2051-SS	B15	C23-3235	B14	CMP1-35KPN	B7	CMS1-5PPB	B9
C13-1341	B12	C21-3035	B13	C23-3236	B14	CMP1-3BBN	B6	CMS1-5PPB-TB	B9
C13-1350	B12	C21-3036	B13	C23-3250	B14	CMP1-3BPN	B6	CMS1-5RBB	B9
C13-1351	B12	C21-3040	B13	C23-3251	B14	CMP1-3KBN	B6	CMS1-5RPB	B9
C13-1440	B12	C21-3041	B13	C23-3335	B14	CMP1-3KPN	B6	CMS2-3BBN	B9
C13-1441	B12	C21-3050	B13	C23-3336	B14	CMP1-3PBB	B6	CMS2-3BPN	B9
C13-1450	B12	C21-3051	B13	C23-3350	B14	CMP1-3PPB	B6	CMS2-3PBB	B9
C13-1451	B12	C23-1135	B14	C23-3351	B14	CMP1-4BBN	B6	CMS2-3PPB	B9
C13-1540	B12	C23-1136	B14	C23-3435	B14	CMP1-4BPN	B6	CMS2-35KBN	B8
C13-1541	B12	C23-1150	B14	C23-3436	B14	CMP1-4KBN	B6	CMS2-35KPN	B8
C13-1550	B12	C23-1151	B14	C23-3450	B14	CMP1-4KPN	B6	CMS2-4BBN	B9
C13-1551	B12	C23-1150-R	B14	C23-3451	B14	CMP1-4PBB	B6	CMS2-4BPN	B9
C13-2140	B12	C23-1235	B14	C23-3460	B14	CMP1-4PPB	B6	CMS2-4KBN	B9
C13-2141	B12	C23-1236	B14	C23-3461	B14	CMP1-4RBB	B6	CMS2-4KPN	B9
C13-2150	B12	C23-1250	B14	C23-3535	B14	CMP1-4RPB	B6	CMS2-4PBB	B9
C13-2151	B12	C23-1251	B14	C23-3536	B14	CMP1-5BBN	B6	CMS2-4PPB	B9
C13-2240	B12	C23-1335	B14	C23-3550	B14	CMP1-5BPN	B6	CMS2-4RBB	B9
C13-2241	B12	C23-1336	B14	C23-3551	B14	CMP1-5KBN	B6	CMS2-4RPB	B9
C13-2250	B12	C23-1350	B14	C23-3560	B14	CMP1-5KPN	B6	CMS2-5BBN	B9
C13-2251	B12	C23-1351	B14	C23-3561	B14	CMP1-5PBB	B6	CMS2-5BPN	B9
C13-2340	B12	C23-1350-R	B14	C25-1000	B16	CMP1-5PPB	B6	CMS2-5KBN	B9
C13-2341	B12	C23-1435	B14	C25-1001	B16	CMP1-5RBB	B6	CMS2-5KPN	B9
C13-2350	B12	C23-1436	B14	C25-1950	B16	CMP1-5RBB-TB	B6	CMS2-5PBB	B9
C13-2351	B12	C23-1450	B14	C25-1951	B16	CMP1-5RPB	B6	CMS2-5PPB	B9
C13-2440	B12	C23-1451	B14	C31-2050	B16	CMP1-5RPB-B	B6	CMS2-5RBB	B9
C13-2441	B12	C23-1450-R	B14	C31-2051	B16	CMP4-5BBB	B8	CMS2-5RBB-TB	B9
C13-2450	B12	C23-1535	B14	C31-2060	B16	CMP4-5BPB	B8	CMS2-5RPB	B9
C13-2451	B12	C23-1536	B14	C31-2061	B16	CMP4U-5PBB	B8	CMS3-3BBN	B9
C13-2540	B12	C23-1550	B14	C31-2080	B16	CMP4U-5PPB	B8	CMS3-3BPN	B9
C13-2541	B12	C23-1551	B14	C31-2081	B16	CMPU-5BBN	B8	CMS3-3PBB	B9
C13-2550	B12	C23-2135	B14	C47-0306-C	B17	CMPU-5BPN	B8	CMS3-3PPB	B9
C13-2551	B12	C23-2136	B14	C47-0316-C	B17	CMPU-5KBN	B8	CMS3-35KBN	B8
C13-3140	B12	C23-2150	B14	C48-03185-C	B17	CMPU-5KPN	B8	CMS3-35KPN	B8
C13-3141	B12	C23-2150-SS	B15	C47-0406-C	B17	CMPU-5PBB	B8	CMS3-4BBN	B9
C13-3150	B12	C23-2151	B14	C47-0416-C	B17	CMPU-5PPB	B8	CMS3-4BPN	B9
C13-3151	B12	C23-2151-SS	B15	C47-0506	B17	CMPU-5RBB	B8	CMS3-4KBN	B9
C13-3240	B12	C23-2235	B14	C47-0516	B17	CMPU-5RPB	B8	CMS3-4KPN	B9
C13-3241	B12	C23-2236	B14	C50-0406-C	B17	CMR1-3BPN	B7		
C13-3250	B12	C23-2250	B14	C50-0416-C	B17	CMR1-3KPN	B7		
C13-3251	B12	C23-2250-R	B14	C50-0506-C	B17	CMR1-3PPB	B7		
C13-3340	B12	C23-2250-SS	B15	C50-0516-C	B17	CMR1-4BPN	B7		

MODEL NO.	PAGE NO.	MODEL NO.	PAGE NO.	MODEL NO.	PAGE NO.	MODEL NO.	PAGE NO.	MODEL NO.	PAGE NO.
CMS3-4PBB	B9	CMT1-4BBN	B10	CSTPK-5PFC-B	B5				
CMS3-4PPB	B9	CMT1-4BPN	B10	CSTPK-5PRS	B5				
CMS3-4RBB	B9	CMT1-4KBN	B10	CSTPK-5PRS-B	B5				
CMS3-4RPB	B9	CMT1-4KPN	B10	CSTPK-5PRS-SP1	B5				
CMS3-5BBN	B9	CMT1-4PBB	B10	CSTPK-5PSP	B5				
CMS3-5BPN	B9	CMT1-4PPB	B10	CSTPK-5PTS	B5				
CMS3-5PBB	B9	CMT1-4RBB	B10	CSTPK-5PUES-3B	B5				
CMS3-5PPB	B9	CMT1-4RPB	B10	CSTPK-5PUES-4B	B5				
CMS3-5RBB	B9	CMT1-5BBN	B10	CSTPK-5PUES-4B-6	B5				
CMS3-5RBB-TB	B9	CMT1-5BPN	B10	CSTPK-5PUP	B5				
CMS3-5RPB	B9	CMT1-5KBN	B10	CSTPK-5PUP-4	B5				
CMS4-35KBN	B8	CMT1-5KPN	B10	CSTPK-5PUS	B5				
CMS4-35KPN	B8	CMT1-5PBB	B10	CSTPK-5PUS-B	B5				
CMS4-3BBN	B9	CMT1-5PPB	B10	CSTPK-5PUSP	B5				
CMS4-3BPN	B9	CMT1-5RBB	B10	CSTPK-5PUSP-B	B5				
CMS4-3KBN	B9	CMT1-5RPB	B10	CSTPK-5PUTS-1B	B5				
CMS4-3KPN	B9	CMT2-3BBN	B10	CSTPK-5PUTS-2B	B5				
CMS4-3PBB	B9	CMT2-3BPN	B10	CSTPK-5PUTS-3B	B5				
CMS4-3PPB	B9	CMT2-3PBB	B10	CSTPK-5PUTS-4	B5				
CMS4-4BBN	B9	CMT2-3PPB	B10	CSTPK-5PUUP	B5				
CMS4-4BBNS	B9	CMT2-5BBN	B10	CSTPK-5PUUP-4B	B5				
CMS4-4BPN	B9	CMT2-5BPN	B10	CSTPK-5PUUP-B	B5				
CMS4-4BPNS	B9	CMT2-5PBB	B10	CSTPK-5RES	B5				
CMS4-4KBN	B9	CMT2-5PPB	B10	CSTPK-5RES-3	B5				
CMS4-4KPN	B9	CMT2-5RBB	B10	CSTPK-5RSP	B5				
CMS4-4PBB	B9	CMT2-5RPB	B10	CSTPK-5RSP-T1	B5				
CMS4-4PPB	B9	CMT3-3BBN	B10	CSTPK-5RTS-1	B5				
CMS4-4RBB	B9	CMT3-5BBN	B10	CSTPK-5RUP	B5				
CMS4-4RPB	B9	CMT3-5BPN	B10	CSTPK-6PBB	B5				
CMS4-5BBN	B9	CMT4-3BBN	B10	CTB-1500	B3				
CMS4-5BBN-TB	B9	CMT4-5PBB	B10						
CMS4-5BPN	B9	CMT4-5PPB	B10						
CMS4-5KBN	B9	CMT5-5BBN	B10						
CMS4-5KPN	B9	CMT5-5BPN	B10						
CMS4-5PBB	B9	CMT5-5PBB	B10						
CMS4-5PBB-TB	B9	CMT5-5PPB	B10						
CMS4-5PBB-SS	B9	CMT5-5RBB	B10						
CMS4-5PPB	B9	CMT5-5RPB	B10						
CMS4-5PPB-SS	B9	CSTPK-1PUP-4B	B4						
CMS4-5RBB	B9	CSTPK-2PUP-4B	B4						
CMS4-5RBB-TB	B9	CSTPK-2PUTS-B	B4						
CMS4-5RPB	B9	CSTPK-3BTS	B4						
CMS5-35KBN	B8	CSTPK-3BTS-7B	B4						
CMS5-35KPN	B8	CSTPK-3BTS-B	B4						
CMS5-3BBN	B9	CSTPK-3PAL	B4						
CMS5-3BPN	B9	CSTPK-3PAL-1	B4						
CMS5-3PBB	B9	CSTPK-3PES	B4						
CMS5-3PPB	B9	CSTPK-3PRS	B4						
CMS5-4BBN	B9	CSTPK-3PSP	B4						
CMS5-4BPN	B9	CSTPK-3PUES-3	B4						
CMS5-4PBB	B9	CSTPK-3PUES-3B	B4						
CMS5-4PPB	B9	CSTPK-3PUES-4	B4						
CMS5-4RBB	B9	CSTPK-3PUES-4B	B4						
CMS5-4RPB	B9	CSTPK-3PUUP-B	B4						
CMS5-5BBN	B9	CSTPK-3PUUP-4B	B4						
CMS5-5BPN	B9	CSTPK-4PBB	B4						
CMS5-5PBB	B9	CSTPK-4PSP	B4						
CMS5-5PPB	B9	CSTPK-4PUTS-1B	B4						
CMS5-5RBB	B9	CSTPK-4RES	B4						
CMS5-5RBB-TB	B9	CSTPK-5BTS	B4						
CMS5-5RPB	B9	CSTPK-5BUP	B4						
CMT1-3BBN	B10	CSTPK-5HPUSP-5	B4						
CMT1-3BPN	B10	CSTPK-5PES	B4						
CMT1-3KBN	B10	CSTPK-5PES-1	B4						
CMT1-3KPN	B10	CSTPK-5PES-2	B4						
CMT1-3PBB	B10	CSTPK-5PES-3	B4						
CMT1-3PPB	B10	CSTPK-5PES-4B-6	B4						



COMPONENT
HARDWARE

1890 Swarthmore Avenue • PO Box 2020 • Lakewood • NJ 08701
Tel. 800-526-3694 • 732-363-4700 • Fax 732-364-8110
www.componenthardware.com

